



Parks and Recreation Commission Meeting

March 2, 2026 at 7 p.m.

Fridley Civic Campus 7071 University Avenue NE

Agenda

Call to Order

Roll Call

Approval of Meeting Minutes

1. February 2, 2026 Parks and Recreation Commission Minutes

Approval of Agenda

Open Forum

The Open Forum allows the public to address the Council on subjects that are not on the Regular Agenda. The Council may take action, reply, or give direction to staff. Please limit your comments to five minutes or less.

New Business

2. Islands of Peace Park History and Background
3. Discussion on the Impact of Federal Immigration Enforcement on Fridley Parks

Old Business

Staff Reports

4. Fridley Parks and Recreation Staff Report

FYSA Report

Adjournment

Accessibility Notice:

- If you need free interpretation or translation assistance, please contact City staff.
- Si necesita ayuda de interpretación o traducción gratis, comuníquese con el personal de la ciudad.
- Yog tias koj xav tau kev pab txhais lus los sis txhais ntaub ntawv dawb, ces thov tiv tauj rau Lub Nroog cove neeg ua hauj lwm.
- Haddii aad u baahan tahay tarjumaad bilaash ah ama kaalmo tarjumaad, fadlan la xiriir shaqaalaha Magaalada.

Upon request, accommodation will be provided to allow individuals with disabilities to participate in any City of Fridley services, programs or activities. Hearing impaired persons who need an interpreter or other persons who

require auxiliary aids should contact CityClerk@FridleyMN.gov or (763) 572-3450.

AGENDA REPORT



Meeting Date: March 2, 2026
Meeting Type: Parks and Recreation Commission
Submitted By: Mike Maher, Parks and Recreation Director
Title: February 2, 2026 Parks and Recreation Commission Minutes

Background

Attached are the meeting minutes of the February 2, 2026 Parks and Recreation Commission.

Recommendation

Staff recommends approval of the February 2, 2026 Parks and Recreation Commission minutes.

Attachments and Other Resources

-
1. PK 02-02-2026

Vision Statement

We believe Fridley will be a safe, vibrant, friendly, and stable home for families and businesses.



Park Commission Meeting

February 2, 2026

7:00 PM

Fridley City Hall, 7071 University Avenue NE

Minutes

Call to Order

Chair Borman called the Parks and Recreation Commission meeting to order at 7:00 p.m.

Present

EB Graham
Peter Borman
Jodi Rehlander
Don Whalen
Riley Auna (Ex-Officio)

Absent

Ken Schultz
Melissa Luna
Tim Kirk

Also Present

Mike Maher, Parks and Recreation Director
Brice Richter, Recreation Coordinator

Approve Parks & Recreation Commission Minutes for January 5, 2026

Motion by Commissioner Graham to approve the January 5, 2026, meeting minutes. Seconded by Commissioner Whalen. The motion passed unanimously.

Approve Parks & Recreation Commission Agenda for February 2, 2026

Motion by Commissioner Rehlander to approve the February 2, 2026, meeting agenda. Seconded by Commissioner Graham. The motion passed unanimously.

Open Forum

No comments.

New Business

1. Pickleball Program Guidelines

Mike Maher, Parks and Recreation Director, stated that staff is preparing for the opening of Commons Park, which includes a six-court pickleball complex.

Brice Richter, Recreation Coordinator, introduced himself and provided a background of pickleball programming in Fridley. He provided additional details on the proposed pickleball program types proposed for Commons Park, as well as structured open play and first-come, first-served play. He reviewed the information that would be available on the dedicated pickleball webpage.

Commissioner Whalen commented on the high level of activity he noticed at the Edgewater Gardens pickleball court this last summer. He asked if there had been any issues with noise related to pickleball. Mr. Richter stated that he has not received any complaints from the existing courts, but noted that it is something they will monitor as this location will have six courts.

Commissioner Rehlander asked if there would be a marketing plan for these courts. Mr. Richter explained that they will utilize the existing email list for leagues, word of mouth, and the overall marketing plan for Commons Park.

Chair Borman recognized that there is nothing planned for Sundays and asked if the space could be reserved. Mr. Richter replied that the intent was to have one day open for first-come, first-served play. He noted that there are no plans at this time to allow reservations of the courts.

2. Election of Vice Chair

Chair Borman opened the nominations for Vice Chair.

Motion by Commissioner Graham to elect Jodi Rehlander as Vice Chair of the Parks Commission. Seconded by Commissioner Whalen.

Commissioner Rehlander accepted the nomination.

The motion passed unanimously.

3. Updated Park System Improvement Plan Implementation Schedule

Mr. Maher provided background information on the Park System Improvement Plan (PSIP) implementation schedule, recognizing that costs have increased since the plan was developed and continue to increase each year. He stated that staff are proposing increased implementation of the remainder of the plan in order to avoid higher costs in the years to follow. He reviewed the construction and community engagement schedule.

Chair Borman asked if there would be coordination between the Harris Lake Park project and the Mississippi road project. Mr. Maher was unsure if the Mississippi construct influenced the phasing, but recognized that at times, there is coordination between construction projects.

Mr. Maher provided updates on the progress for Commons Park, Flanery Park, and Summit Square Park. He provided an overview of the parks and concepts proposed for 2027, which will go through the community engagement process in 2026. He briefly noted the parks proposed for 2028, with community engagement in 2027.

Chair Borman referenced Innsbruck, which he commented is not really a park, and asked if there are any ideas or concepts for that area. Mr. Maher replied that the primary improvements would be to the parking areas and walking trails. He stated that while there are no traditional amenities, it is still a well-used park.

Commissioner Auna asked for information on the marketing that would be done for community engagement. Mr. Maher provided information on that process, which includes online and in-person opportunities to provide input. He noted that once the accelerated plan is approved, they would also advertise the updated implementation plan through other City platforms such as social media and the City newsletter. He asked the Commission to spread the word through the community as well.

Commissioner Rehlander asked if there would be a backout plan for the accelerated implementation if something happens, using the example that they run out of money. Mr. Maher provided additional information on the City budget process and noted that the plan would continue to be reviewed each year through the budgeting process.

Motion by Commissioner Graham to approve the updated Park System Improvement Plan Implementation Schedule. Seconded by Commissioner Whalen. The motion passed unanimously.

Mr. Maher noted that on future agendas he would include a standing item for FYSA Report, but suggested that it take place here for tonight's meeting.

Ex-Officio Commissioner Auna provided updates for football, baseball, and soccer, noting upcoming registrations and information on the anticipated number of participants and percentages of Fridley residents. He noted a recent concern related to ICE and whether they would be allowed within the parks, and how they could protect those in the parks for sports programs. He provided information on a recent basketball clinic, which is the first of five clinics to be conducted.

Commissioner Rehlander asked that an item be included on the next agenda to consider a policy recommendation for an amendment to the City's current statement on immigration enforcement from 2017. She stated that she has proposed a draft of proposed language for the Commission to consider. She recognized the multi-million dollar investment the City is making in the parks and wants to ensure that community members can enjoy those amenities without fear.

Old Business

Staff Reports

4. Fridley Parks and Recreation Staff Report

Mr. Maher reviewed his written report, highlighting information on after-school classes and the invasive species removal project at Innsbruck. He recognized the Fridley Lions, who will be raising funds for a new fishing pier at Moore Lake Park during their Winter Warmup event on February 27th. He noted the upcoming Winterfest, which will take place this Saturday at Springbrook Nature Center from noon to 3 p.m. He highlighted other upcoming events and noted upcoming registration dates.

Chair Borman encouraged residents to attend the Fridley Lions Winter Warmup on February 27th. He believed that this was the 18th year for the event and provided information on how to purchase tickets.

Mr. Maher stated that in April, a contractor will come in to update the AV system in the Council Chambers, and therefore, they will look at alternative locations for that meeting. The Commission suggested meeting at Moore Lake if the building is available.

Adjournment

Commissioner Rehlander made the motion to adjourn the meeting at 8:24 p.m. Seconded by Commissioner Whalen. The motion passed unanimously.

Respectfully submitted,

Mike Maher, Staff Liaison

AGENDA REPORT



Meeting Date: March 2, 2026
Meeting Type: Parks and Recreation Commission
Submitted By: Mike Maher, Parks and Recreation Director
Title: Islands of Peace Park History and Background

Background

Islands of Peace Park is currently operated by Anoka County Parks as a regional park. Park property is owned by the City of Fridley and a joint powers agreement has been in place since 1981 to outline the details of this arrangement.

Noting that the joint powers agreement has become outdated in several regards, preliminary discussions have been held between the two organizations to explore options including updating the agreement and/or a transfer of property.

Additional details will come before the Commission in 2026 and a presentation from Anoka County Parks is being planned for a future meeting. To prepare the Commission for a thoughtful process to provide input, staff have compiled information on the agreement and park history.

Islands of Peace Park was one of the first accessible nature-based parks in Minnesota and the effort to establish the park was spearheaded by Fridley resident Ed Wilmes, for whom a separate Fridley park is named. Additionally, one function of the park currently is that the park welcome center currently serves as the administrative office of the Minnesota Recreation and Parks Association (MRPA).

With Islands of Peace Park having been designated as a regional park, Anoka County is eligible to receive funding for the park through legislation, grants, etc. where cities such as Fridley are not recognized as being eligible to operate Regional Park facilities and receive funding for their operation and/or improvement.

Recommendation

Attachments and Other Resources







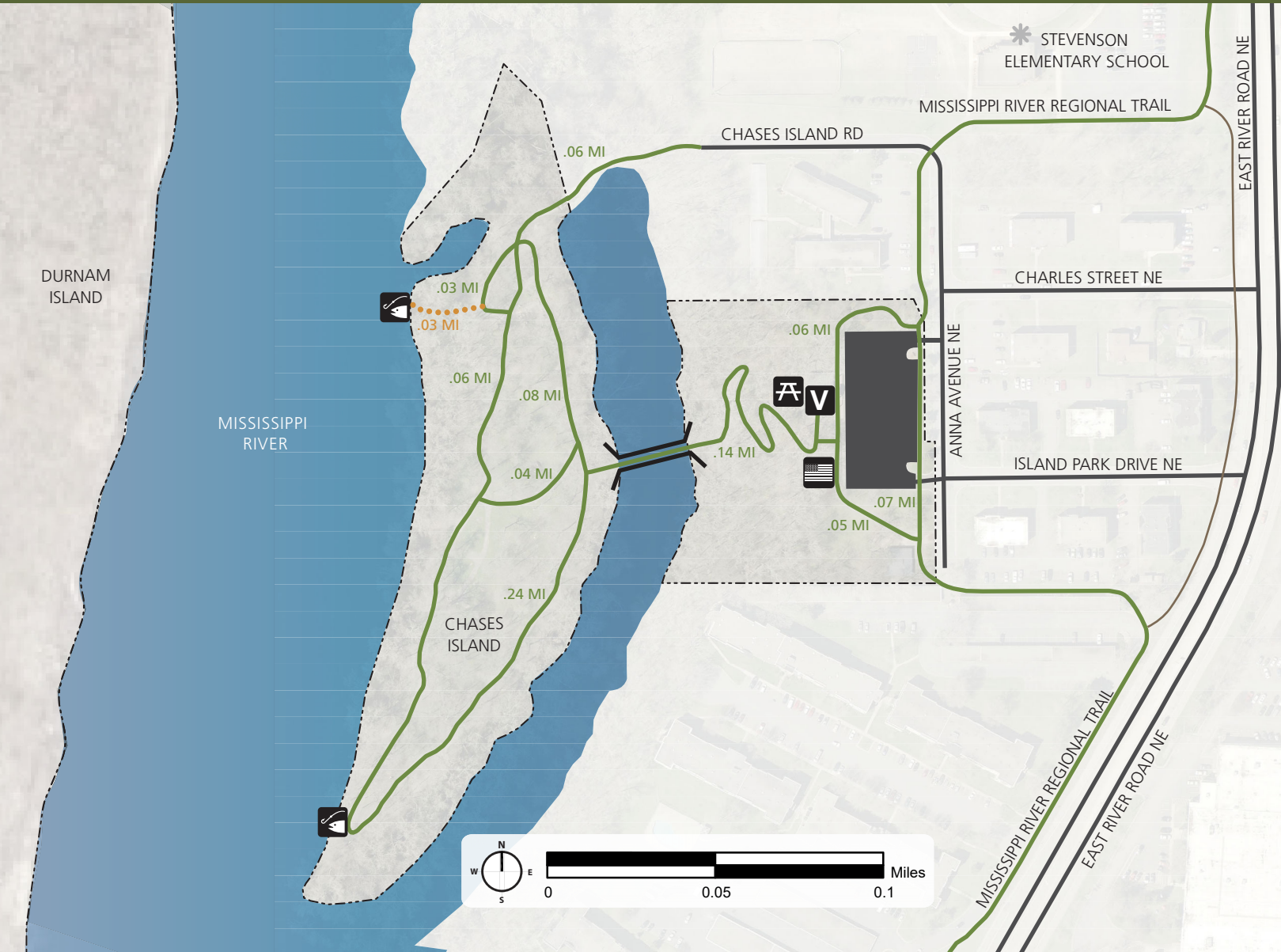

1. IOP-pocket-summer19-8.5x11_2019_Map
2. Islands of Peace Joint Powers Agreement
3. Is of Peace Park Master Plan.original
4. Anoka-County-Riverfront-Regional-Park-Master-Plan-Amendment

Vision Statement

We believe Fridley will be a safe, vibrant, friendly, and stable home for families and businesses.

ISLANDS OF PEACE REGIONAL PARK



-  PARK BOUNDARY
-  PAVED ROADS
-  PAVED TRAILS / REGIONAL TRAILS
-  UN-PAVED TRAILS
-  MUNICIPAL TRAILS
-  VISITOR CENTER / OFFICES OF THE MINNESOTA RECREATION AND PARKS ASSOCIATION
-  PICNIC AREA
-  SHORE FISHING
-  VETERAN'S MEMORIAL

*NOTE: TRAIL DISTANCES ARE SHOWN FOR SEGMENTS WITHIN THE PARK AND BETWEEN TRAIL INTERSECTIONS OF THE SAME TRAIL SURFACE TYPE.

REGIONAL PARK
JOINT POWERS AGREEMENT

THIS AGREEMENT, entered into this 10th day of February, 1981, by and between the County of Anoka, a political subdivision of the State of Minnesota, Courthouse Building, Anoka, Minnesota, 55303, hereinafter known as "County"; and the City of Fridley, a municipal corporation of the State of Minnesota, 6431 University Ave. N.E., Fridley, Minnesota, 55432, hereinafter known as "City";

WITNESSETH THAT:

WHEREAS, the Minnesota Legislature has delegated to the County of Anoka the responsibility of implementing a regional park facility to be known as the Mississippi River - Islands of Peace Regional Park; and

WHEREAS, the County of Anoka has developed through study and evaluation a park development plan, known as the Mississippi River - Islands of Peace Regional Park Master Plan, attached hereto as Exhibit A and hereby by reference made a part hereof; and

WHEREAS, the City currently owns and maintains an island known as Chase's Island, more particularly described in Exhibit B attached hereto, the location of which is shown in a map attached hereto as Exhibit C; and

WHEREAS, the City currently owns and maintains a recreational park known as the Hayes Lots, described in Exhibit B attached hereto, the location of which is shown on a map attached hereto as Exhibit C; and

WHEREAS, the City currently leases and maintains a recreational park known as Gil Hodges Island, which island is owned by the Minnesota Department of Natural Resources, more particularly described in Exhibit D attached hereto the location of which is shown on Exhibit E attached hereto; and

WHEREAS, residents of the County and City use Hayes Lots, Chase's Island and Gil Hodges Island for picnicking and recreational outings; and

WHEREAS, these parks are included within the proposed Mississippi River - Islands of Peace Regional Park; and

WHEREAS, the greatest number of users of Hayes Lots, Chase's Island and Gil Hodges Island come from outside the City and are residents of the County; and

WHEREAS, the proposed Mississippi River - Islands of Peace Regional Park would increase the number of park users; and

WHEREAS, certain substantial economic savings can be realized by the residents of the County and the City through a cooperative operating and maintenance agreement;

NOW, THEREFORE, in consideration of the mutual covenants and agreements contained herein, and pursuant to Section 471.59 of the Minnesota Statutes, the County and the City do hereby agree as follows:

I.

PURPOSE

The parties hereto agree that they have joined together for the purpose of promoting the efficient development,

operation and maintenance of Hayes Lots, Chase's Island and Gil Hodges Island to serve the recreational needs and interests of park users, including the handicapped and disabled.

II.

INTENT.

It is the intent of this agreement to outline the responsibilities of the City and the County in the areas of development, operations and maintenance of Hayes Lots, Chase's Island, and Gil Hodges Island.

III.

RESPONSIBILITIES

The County shall have the following responsibilities for Hayes Lots, Chase's Island and Gil Hodges Island:

A. County Responsibilities:

1. To provide routine maintenance on a scheduled basis by the County Parks Department of the grounds and buildings at a minimum according to the standards of the County Parks Department, as provided for in the Master Plan attached as Exhibit A.
2. To provide routine maintenance of trails and parking lots on a scheduled basis by the County Parks Department, at a minimum according to the standards of the County Parks Department, as provided for in the Master Plan attached as Exhibit A.
3. To provide other maintenance services including but not limited to cutting grass, controlling noxious weeds and grasses, picking up and removing litter, snow removal, wash-out repairs, at a minimum according to the standards of the County Parks Department as provided for in the Master Plan attached as Exhibit A.
4. To provide effective tree disease control program in cooperation with City of Fridley tree inspector.

5. To pay for utility costs and the cost of installing a security alarm system selected by the County Parks Director and the City Parks Director.
6. To provide proper identification signs for the park. The City must concur with use of any proposed signs, and such concurrence shall be in writing addressed to the Anoka County Parks Director. The City hereby concurs in the erection of a sign similar to that shown in Exhibit F attached hereto.
7. To participate in certain improvements with the City such as the planting of additional trees and shrubs, landscaping, and such other improvements as the parties may, from time to time, agree shall be made.
8. To schedule activities. Any special activity scheduled in the park by the County which is not in keeping with the normal day to day use of the park should be concurred with by the City Council before such activity is held.

The City understands and agrees that the County may, from time to time, use the services of third parties to determine the content and conduct of activities on the properties in question on behalf of handicapped and disabled citizens. The City agrees that the County may make the facilities on the subject property available to such third parties, including by lease of the subject property, with concurrence of the City. Such concurrence shall be in writing addressed to the Anoka County Parks Director. If the City fails to respond in writing within 30 days after written notice by the County under this section, it shall be conclusively presumed that the City has concurred.

The County acknowledges the City has certain obligations pertaining to the use of the subject property that have been incurred through the use of state grants. The County agrees to operate the subject property in accordance with state obligations of which it has written notice sent to the County Parks Director.

9. To establish and to collect user fees, if any, in accordance with the standards of the County Parks Department and approved by the City Council to include the County policy for handicapped (all handicapped will be admitted at no charge to any and all County parks).
10. The City hereby grants to the County the right to occupy and use the subject property according to the terms and conditions of this Agreement.

The City shall have the following responsibilities for Hayes Lots, Chase's Island and Gil Hodges Island:

B. City Responsibilities:

1. To provide City heavy Equipment to assist County crews on special projects if City has equipment available.
2. To provide necessary rights to Anoka County for location and installation of Mississippi River - Islands of Peace Regional Park, as provided in Exhibit A attached hereto.
3. To provide upkeep and maintenance of all City streets that provide access to parkways and parking lots.

IV.

EMPLOYEES

All persons hired by the County, whether to provide maintenance or other services in connection with the exercise of the authority conferred upon the County by the City shall be under the exclusive control and supervision of the County. No such persons shall be deemed to be employees of the City.

The County shall have the exclusive right to determine the number of employees which shall be necessary to carry out the responsibilities assumed by the County, and to select those persons the County deems most qualified to perform the necessary services.

V.

CAPITAL IMPROVEMENTS

Any development plans made by the County to improve the park facilities other than the normal maintenance activities shall be approved in writing by the City Council. Any capital improvements provided for in the Master Plan on file with the Metropolitan Council are hereby deemed approved

and no further approval by the City is necessary. The City and County will meet periodically to discuss and review the work and development plan.

VI.

APPROVALS

Wherever in this Agreement concurrence or approval by one party is required before action is taken by the other party, the failure to respond to a written proposal within thirty (30) days shall be considered concurrence and approval.

VII.

INSURANCE

Both parties shall maintain their own liability insurance for property damage and personal injury resulting from the use of the park facilities. The minimum limits of liability for such insurance shall be those limits of both parties for their general liability policy at the time this Agreement is executed.

VIII.

POLICE AND FIRE PROTECTION

The City shall provide normal police and fire protection consistent with the level of normal service provided to the general public in the City.

The County agrees to furnish special park patrol personnel for the safety and well being of the park users and protection of the facilities in accordance with the standards of the County Parks Department.

IX.

ORDINANCE

The property described herein, known as Hayes Lots, Chase's Island and Gil Hodges Island, shall be governed by Anoka County Ordinance No. 70-2, as amended by Ordinance No. 80-6, an Ordinance Regulating County Parks, a copy of which is attached hereto as Exhibit G and hereby made a part hereof by reference.

X.

DEFAULT

If either party fails to perform any of its responsibilities as outlined herein, within 48 hours after written notification by the other party hereto, the other party may perform the task and charge the defaulting party the reasonable value of such services.

XI.

TERMINATION

This agreement may be terminated by either party at any time, with or without cause, upon 365 days written notice delivered in person, or by mail, to the other party. For purposes of delivering such notice, the addresses of the parties are set forth above in this Joint Powers Agreement.

Upon termination of this Agreement by the City, the City shall maintain the Hayes Lots, Chase's Island and Gil Hodges Island for such period of time as the Mississippi River - Islands of Peace Regional Park is in use by the general public.

XII.

SEVERABILITY

The provisions of this Agreement are severable. If any paragraph, section, subdivision, sentence, clause, or phrase of this Agreement is for any reason held to be contrary to law, or contrary to any rule or regulation having the force and effect of law, such decision shall not affect the remaining portions of this Agreement.

XIII.

EFFECTIVE DATE

This Agreement shall become effective upon the signature of all duly authorized parties.

IN WITNESS WHEREOF, the parties hereto have executed this Agreement.

COUNTY OF ANOKA

By: [Signature]
Chairman of County Board

Dated: February 10, 1981

CITY OF FRIDLEY

By: [Signature]

Dated: February 10, 1981

ATTEST:

By: [Signature]
Anoka County Administrator

Dated: February 10, 1981

ATTEST:

By: [Signature]

Dated: February 10, 1981

MISSISSIPPI - ISLANDS OF PEACE REGIONAL PARK MASTER PLAN

Prepared for

Anoka County Park and Recreation Department

By

Barton-Aschman Associates, Inc.

TABLE OF CONTENTS

	<u>Page</u>
SELECTION	
Background	1
Site Description	2
Existing Land Use	2
Planned Land Use	2
Public Involvement	4
Development Concept	4
ACQUISITION	
FMC Property	7
Durnam Island	7
Islands of Peace Park	7
Trail Easements	8
DEVELOPMENT	
Policy Implementation	9
Potential Outdoor Recreation Uses	9
- Picnicking	
- Trails	
- Fishing	
- Boating	
- Field Games	
Development Program	12
Operations and Maintenance	12
- Fire and Police Services	
- Grounds Maintenance	
- Programmed activities	
APPENDIX	
A Correspondence	16
B Parcel Descriptions	24
C Five Year Capital Improvements Program	33

SELECTION

Background

The Mississippi River forms Anoka County's western boundary, following a winding 18 mile course between the City of Minneapolis to the south and Sherburne County at the Northwest. Between the Coon Rapids Dam and the river gorge below St. Anthony Falls, the Mississippi presents varied scenic features: high banks alternate with lowland areas; portions of the shoreline are heavily wooded; the river is interspersed with islands.

The recreational potential of this corridor has long been recognized. Through its 1969 Comprehensive Plan for Parks and Open Space, Anoka County identified the public benefit of preserving the Mississippi's islands and shorelands, thus enhancing the river corridor's potential for hiking, bicycling, boating and canoeing, fishing, and for other more passive recreational pursuits. The regional values of this corridor's recreational resources have repeatedly been recognized by the Metropolitan Parks and Open Space Commission and the Metropolitan Council. The Mississippi Islands area was designated as a proposed regional park site in the 1975 Recreation Open Space Policy Plan section of the Metropolitan Development Guide. Subsequently, the Council has expanded this proposed regional recreation resource by identifying the Mississippi corridor as part of its proposed multi-purpose regional trail system. More recently, in April, 1979, Anoka County was authorized by the Council to prepare a regional park master plan for Mississippi-Islands of Peace Park.

This document sets forth Anoka County's Master Plan for Mississippi-Islands of Peace. As proposed, the Park will encompass Durnam, Gil Hodges, and Chase's Islands and approximately one and one half miles of river shorelands in the City of Fridley, along one of the few sizeable scenic undeveloped reaches of the Upper Mississippi in the Region's urbanized area. The park will accommodate water-oriented and other active and passive activities. A multi-purpose trail will offer hiking and bicycling opportunities and will provide key linkages between Mississippi-Islands of Peace and other regional open space areas to the north, east and south. Development of the park and trail will implement an especially significant segment of the Great River Road Trail, and the park will function as an important recreation node along the Mississippi Great River Road.

Site Description

Mississippi-Islands of Peace Park is sited in southern Anoka County in the City of Fridley. The park and adjacent areas are shown on Figure 1. The three major land elements comprising the proposed park are: (1) 60 acres of river shorelands (the FMC Property) located between East River Road and the Mississippi River, north of the Minneapolis Water Works grounds; (2) the existing Islands of Peace Park which occupies Chase's Island, Gil Hodges Island, and the two on-shore Hayes Lots; and, (3) Durnam Island, approximately 56 acres of bottomland forest habitat. Durnam and Gil Hodges Islands and, to a great extent, Chase's Island present undisturbed examples of Mississippi floodplain vegetation and wildlife. Portions of the FMC property have been altered from its natural condition. Much of the property was originally low, and in the late 1960's was filled with sand, clay, rock and construction excavation materials with topsoil spread over.

Existing Land Use

Durnam Island is privately owned. The Island has been left in the natural state. Gil Hodges Island is owned by the State under the Department of Natural Resources (DNR) control; however, this island has been leased to the City of Fridley. The City has in turn leased it to the Islands of Peace Foundation, a private non-profit organization. The Island has been left in its natural state. In addition to Gil Hodges Island, Islands of Peace Park is comprised of two other properties owned by the City of Fridley which are leased to the Foundation. These are Chase's Island and the on shore Hayes Lots.

Islands of Peace Park provides a recreation facility available to the general public which has been designed to minimize restrictions for the physically handicapped. The Foundation provides special programmed activities oriented toward the disabled.

The 60-acre property owned by the FMC Corporation is basically open undeveloped land. Occassionally a hay crop is cut. A small area near East River Road is used for garden plots by FMC employees. There are two residential structures on the property. A small house is rental property. The larger house, called "The Farm", is used to provide meeting facilities and lodging for visiting corporate executives.

Planned Land Use

Mississippi Islands of Peace Park is within the Mississippi Critical Area boundaries. In its plan for the Critical Area, Fridley has designated the regional park and trail as the appropriate land uses for the corridor.

East River Road is a segment of the Great River Road. A project development report (PDR) to acquire and develop the FMC portion of the regional park has been approved for the purpose of providing recreational day use activities along the Great River Road, and to preserve scenic river frontage.

Figure 1

Mississippi- Islands of Peace
Regional Park Location

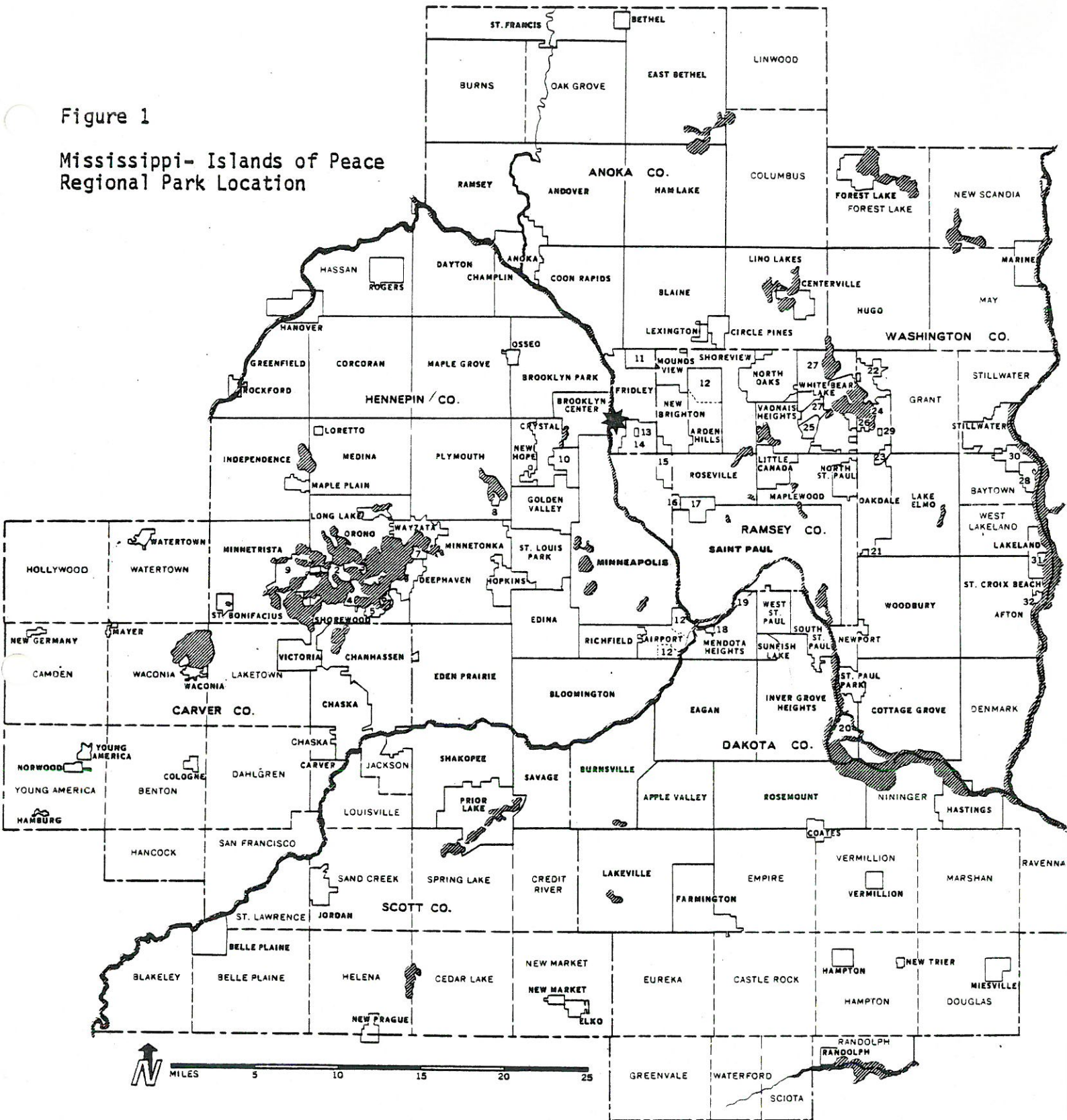

TWIN CITIES METROPOLITAN AREA
Political Boundaries, 1979

- | | | | |
|--------------------|---------------------|-------------------|---------------------|
| 1 SPRING PARK | 9 MOUND | 17 FALCON HEIGHTS | 25 GEM LAKE |
| 2 ORONO | 10 ROBBINSDALE | 18 MENDOTA | 26 BIRCHWOOD |
| 3 MINNETONKA BEACH | 11 SPRING LAKE PARK | 19 LILYDALE | 27 WHITE BEAR |
| 4 TONKA BAY | 12 U. S. GOVT. | 20 GREY CLOUD | 28 BAYPORT |
| 5 EXCELSIOR | 13 HILLTOP | 21 LANDFALL | 29 WILLERNIE |
| 6 GREENWOOD | 14 COLUMBIA HEIGHTS | 22 DELLWOOD | 30 OAK PARK HEIGHTS |
| 7 WOODLAND | 15 ST. ANTHONY | 23 PINE SPRINGS | 31 LAKELAND SHORES |
| 8 MEDICINE LAKE | 16 LAUDERDALE | 24 MANTOMEDI | 32 ST. MARY'S POINT |

ANOKA — County Boundary
ORONO — Municipal Boundary
CAMDEN — Township Boundary

Public Involvement

Opportunities for public participation in planning for Mississippi-Islands of Peace date from the public hearing on the Regional Recreation Open Space Plan in 1975, when the general location of the park was first proposed. Other notable occasions for public involvement in the conceptual development of the park were the development of the Regional Trails Systems Plan and through designation of the Great River Road route. A public hearing on the Project Development Report for Great River Road Acquisition of the FMC property has been tentatively scheduled for early 1980. Detailed opportunity for consideration of the park proposal has been afforded during preparation of Fridley's Critical Areas Plan.

Support for the existing Islands of Peace Park has come from a variety of public and civic sources. Resolutions supporting the activities of the Islands of Peace Foundation have been adopted by the City of Fridley, the City of Brooklyn Park, and the Hennepin County Board of Commissioners. Members of the Minneapolis Building and Trades/ Council, AFL-CIO, donated their labor, enabling construction of a reception center/activities building for the park. Most recently, the Governor's office has praised the Foundation's efforts in serving the handicapped.

Development Concept

The general development proposed for Mississippi-Islands of Peace Park is shown on Figure 2. Following acquisition of the FMC property, this portion of the Park will be developed as a day use facility. Blacktop bicycle and hiking trails will traverse the property. The trail route has been layed out so as to enable linkage with the City of Minneapolis' system to the south. The trails will mainly follow the bluff line, with rest areas provided at scenic overlooks. Two picnic shelters with tables and grills will be located in a picnic grove at the central portion of the park. Restrooms, water, and other support facilities will also be provided. A field games area will be developed. The entire site will be landscaped with shade trees and shrubs consisting of a mixture of varieties suited to the site (ash, maple, linden, Norway Spruce, Russian Olive, Amar maple, and others). Access to the park will be at 51st Way and East River Road. A 3/4 mile blacktop road will direct park users to parking areas. Lands owned by MnDOT immediately north of the FMC property are proposed to be developed to provide public access to the river for boating activities. 

"The Farm", a large residential structure located on the site, will be used as an activity center for community functions. There is also discussion of developing the facility as a "Hall of Fame" to recognize the accomplishments of disabled persons. 

Easements will be acquired to continue the trail, north across MnDOT properties beneath the I-694 bridge, then along the river's edge behind high density residential units, finally connecting with Islands of Peace Park. Within Islands of Peace, the multi-purpose trail will be split, with a bicycle trail remaining on-shore and the hiking trail running the length of Chase's Island. The trails have been located to enable connection with other parts of the Regional Trail System. As the trail exits the Islands of Peace, it continues north, passing by Manomin County Park and ultimately reaching the Coon Rapids Dam Regional Park. A connection with the

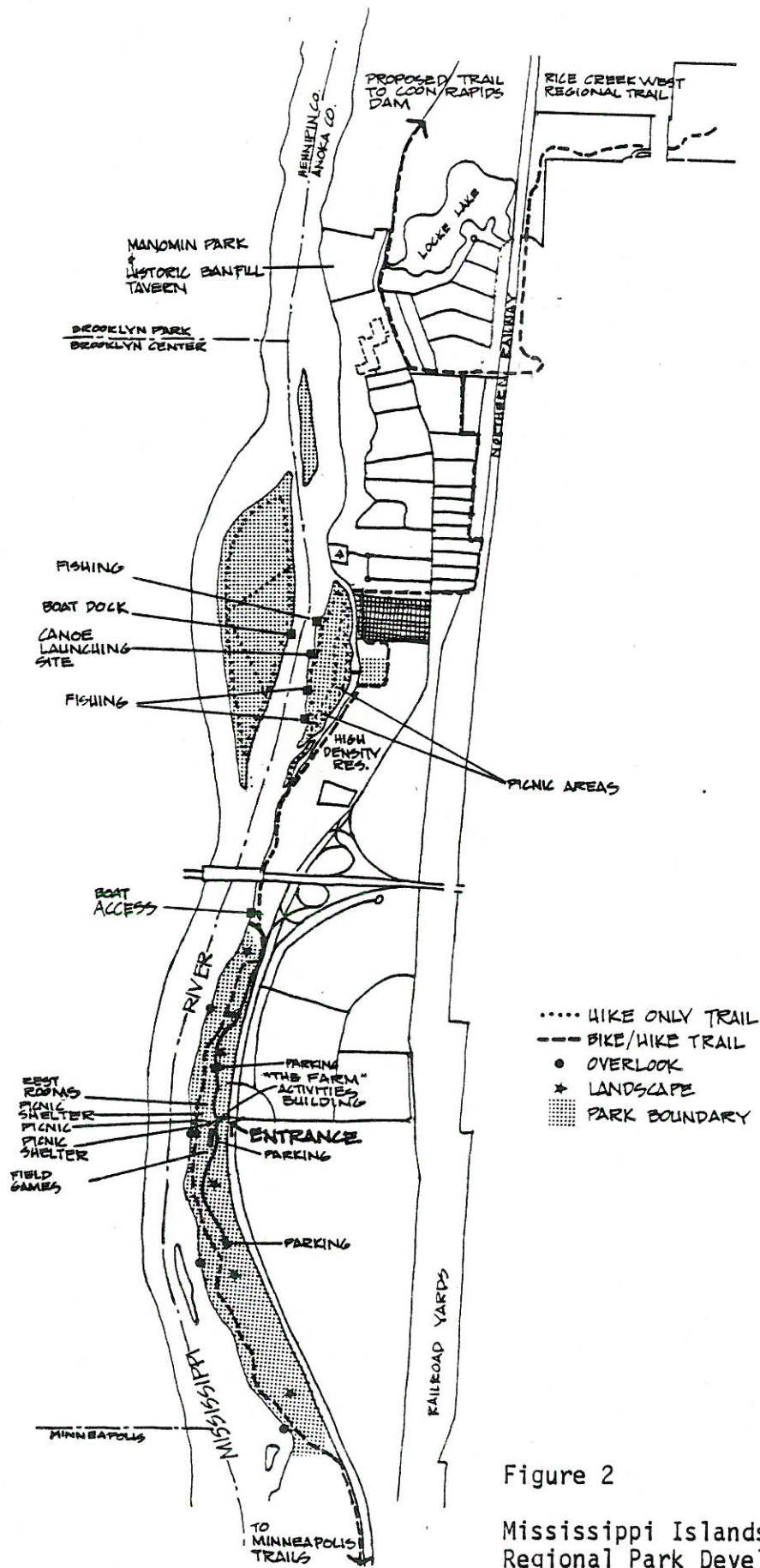

Figure 2

Mississippi Islands of Peace
Regional Park Development Plan

Rice Creek regional trail is made at Mississippi Way. It is expected that regional monies will be made available in the future to enable completion of the trail corridor.

Gil Hodges Island will remain undeveloped as a wildlife refuge. Durnam Island will be provided with a boat dock on its east shore, and a system of interpretive trails will be developed. The island will remain in its natural state in all other respects. Staff of The Nature Conservancy have inventoried the islands. They found the island to be an excellent example of undisturbed floodplain forest community, all the more remarkable due to its location within an urbanized area.

Trail crossings to Chase's Island will require the construction of footbridges. These crossings will require a permit to work in public waters from the Department of Natural Resources (DNR). The development proposal for the park has been reviewed by the DNR Regional Hydrologist. Conceptual approval for the crossings has been expressed in correspondence found in Appendix A.

ACQUISITION

Acquisition of all park properties are anticipated to occur in one phase.

FMC Property

The 60-acre FMC property consists of four separate parcels owned by the FMC Corporation. A figure showing each parcel and legal parcel descriptions can be found in Appendix B. All parcels are to be acquired simultaneously. The estimated cost of purchase is \$2,280,000. The estimate was arrived at by using comparables provided by the American Appraisal Company:

1. Sale of the Burlington Northern Industrial Park (directly east of the FMC property), in March, 1979, in the amount of \$1.21 per square foot.
2. Sale of the GTE Sylvania, Inc. property in November, 1975, at \$1.15 a square foot.

Also taken into consideration was the Anoka County Assessor's finding that light industrial properties are presently assessed at an average of \$38,000 per acre.

Incidental costs associated with acquisition are two certified appraisals at \$9,000 each and a certified survey, at approximately \$4,000.

Development of the properties for public recreational use will result in loss of \$12,340.72 annually in tax revenues.

Durnam Island

Durnam Island consists of three parcels in private ownership. Legal descriptions and a map showing the parcels can be found in Appendix B. Acquisition costs for these properties have been estimated to be \$80,000. Acquisition of the island for park use will result in loss of approximately \$826.30 annually in tax revenues.

Islands of Peace Park

Four properties comprise the existing Islands of Peace Park: Gil Hodges Island, Chase's Island, and two lots in the Hayes Subdivision. Gil Hodges Island is owned by the Department of Natural Resources. The agency has leased the island to the City of Fridley. In turn, the City has leased it to the Islands of Peace Foundation. The remaining properties are owned by the City of Fridley (see Appendix B for legal descriptions) and also are leased to the Foundation. This lease is scheduled to terminate in July 31, 2002.

Acquisition of these properties is not deemed necessary at this time. A joint agreement between Fridley, the Foundation, and Anoka County will transfer all operations and maintenance responsibilities to the County. The Foundation will be requested to continue to provide special programming at the park. ←

Trail Easements

Development of the trail linking Islands of Peace and the FMC property is dependent upon securing easements for the trail corridor. An easement must be negotiated with the Minnesota Department of Transportation (MnDOT) to cross the I-694 right-of-way. This agreement must also identify the appropriate means of developing the trail beneath the Interstate Bridge. Correspondence with MnDOT is included in Appendix A which expresses the agency's conceptual approval of development proposed for the park.

An easement to be obtained from the Georgetown Apartments will provide for approximately 500 feet of multi-purpose trail and 1,500 feet of bicycle trail along the shoreline.

It has been estimated that all necessary easements can be obtained at a cost of approximately \$5,000.

DEVELOPMENT

Policy Implementation

Pursuant to the policies established in the Metropolitan Council's "Development Guide for Recreation Open Space", a regional park classification is appropriate for the proposed Mississippi-Islands of Peace Park:

Regional parks should contain a balance between unique natural resources and outdoor recreation opportunity. For this reason, they should be located where prime resources, such as water bodies and water courses exist within the areas of high demand for outdoor recreation.

Recreation use is to be oriented towards the utilization of the resources for the enhancement of the outdoor recreation experience rather than the structured protection theme maintained in the park reserves.

Proposed development for the park is also consistent with the policies of Anoka County's Comprehensive Park and Open Space Plan:

Priority in acquisition should be placed on stream and lakeshore property ... (and on) sites which can most readily serve concentrations of people resident in urban areas.

Use of all county park sites must be assured the full general public, including all special arrangements made with communities and organizations.

Where feasible, and especially along rivers and streams, parkland should be inter-connected, with trails, pathways, paths, etc., permitting persons to travel safely from one area to another.

Potential Outdoor Recreation Uses

Any consideration of recreational use of this site must recognize that the primary reason for regional park interest in the site is because of the Mississippi itself. The proposed acquisition and development program will provide a recreational facility needed to serve the people of the northern metropolitan suburbs and portions of the Minneapolis fully developed area.

This regional facility will offer recreational experiences quite different from smaller local parks. Large picnic areas and shelters will be provided, also nature and walking trails, bicycling trails, shore fishing, boating and canoeing, boat launching, field games, and passive recreational activities. The major activities are discussed below.

Picnicking - Picnicking is expected to be a major recreational activity. Based on an extensive survey of regional park users, the Metropolitan Council has developed a method of forecasting activity demand for the peak summer recreation season. For picnicking, the Council has estimated that Mississippi-Islands of Peace will draw picnic use by 12,000 to 15,000 persons during the summer season.

The Council's use estimates for picnicking and other activities are summarized on Figure 3. Also shown are the primary service areas for the park. Heaviest use is forecast for the southern Anoka County communities. The next most intense demand is found in adjacent readily accessible areas: North and Northeast Minneapolis, Brooklyn Center, Moundsview, and New Brighton. A third tier of communities significantly influencing park use are formed by Brooklyn Park, Coon Rapids, and Blaine. Other areas forecast to place a small but appreciable demand on the facility form a fourth tier adjacent to the core demand area.

Picnicking activity at Mississippi-Islands of Peace will be accommodated at two sites. Development of two shelters, 20 tables and grills, and restrooms and other support facilities are proposed for the central portion of FMC property. Field game areas, parking, and trails will be readily accessible. The other major focus of picnicking activity will be at the Islands of Peace area. Picnicking will be concentrated on Chase's Island with a few tables provided near the reception center. A total of 25 tables and grills are proposed for this area.

Trails - Trails are the integral element of overall park development, connecting the park's various use areas and linking Mississippi-Islands of Peace with other facilities of the regional open space system. The Metropolitan Council demand study has forecast trail use to be the dominant use for the park, with as many as 25,000 users forecast for the summer season alone.

Approximately 5.5 miles of trails are proposed for the park. Of this total, 2.8 will be multi-purpose paved walking and bicycling trails. Roughly 0.6 miles will provide a separate bicycle trail by-passing Chase's Island. A separate trail has been provided in this portion of the park in order to lessen the risk of conflict with wheelchair bound trail users who are expected to use the Chase's Island facilities somewhat more intensively. Finally, 2.1 miles of walking and interpretive trail are to be developed on Durnam Island.

Fishing - The Upper Mississippi is a good fishing resource, providing opportunity for bass, panfish, walleye, and other species. On-shore and off-shore fishing will be a major activity in Mississippi-Islands of Peace. The recreation section of the Twin Cities Area Level B Study shows participation by 50 to 60 percent of the population, with an annual per capita participation rate between 1.4 and 1.5. The Metropolitan Council's recent park user study showed consistently high shore fishing activity. In most of the parks inventoried, bank fishing accounted for 50 to

SERVICE AREA ANALYSIS

Figure 3

FACILITY(■):

Mississippi Islands of Peace
Regional Park

Total Summer Season Use:

Picnic Use:	12,000-15,000
Boat Launch:	6,500
Trail Use:	25,000
Misc. Uses:	3,500

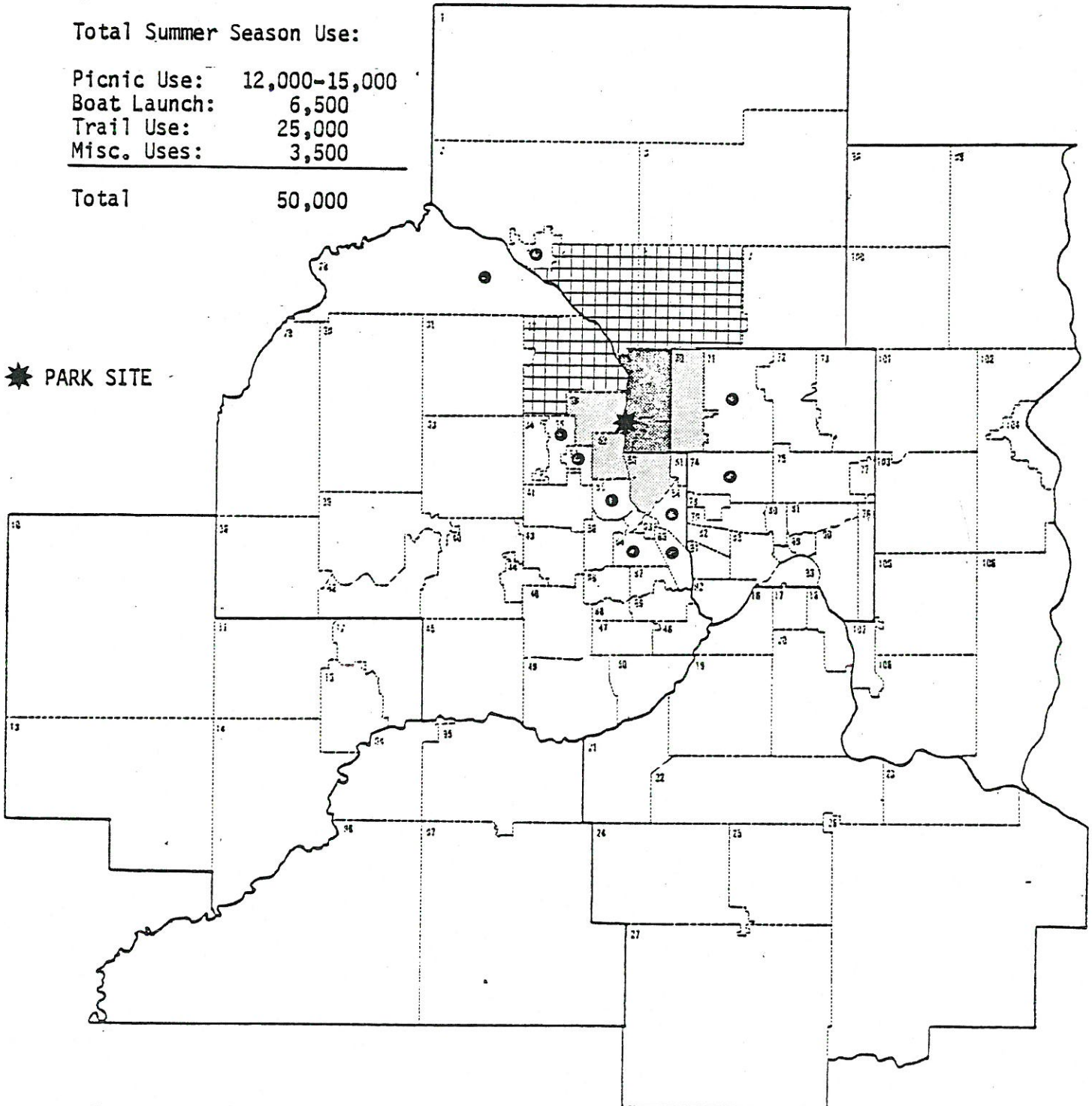

Total	50,000
--------------	---------------

★ PARK SITE



PRIMARY SERVICE AREA

Those districts providing over 10%
of the facility's use

	over 20%		10-20%
---	----------	---	--------

SECONDARY SERVICE AREA

Those districts providing between
2 and 10% of the facility's use

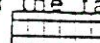

REMAINING SERVICE

Those districts providing less than
2% of the facility's use



Sample Size:



Non-Metro Use(%):

3%

200 users per day, everyday during the summer. At Mississippi-Islands of Peace, bank fishing opportunities at the FMC property will be available on an informal unstructured basis. At the Islands of Peace area, five fishing piers will be developed on Chase's Island.

Boating

Boating is a popular activity on Upper Mississippi. This stretch of the river is fairly placid and is suited to power boating and to canoeing and kayak use. There are relatively few access opportunities along this stretch of the river, thus proposed access sites are expected to receive fairly heavy use. The Metropolitan Council demand forecast for Mississippi-Islands of Peace estimates 6,500 users of a launch site during the summer.

Launching facilities will be available for powerboat users, provided an easement can be negotiated for use of MnDOT lands north of the FMC property. A concrete ramp will be provided, as will as parking space for approximately 25 vehicles and trailers.

To minimize possible conflict with power boats, the launch area for canoes, kayaks, and other carriable craft has been sited in the Islands of Peace area, on Chase's Island.

It has been recognized that a proportion of users will reach the park via the river itself. A beaching area for small craft and docking space for powerboats have been planned for Durnam Island. ?

Field Games - In conjunction with the FMC picnic area, open areas will be devoted to field game uses. Ballfields will be provided, as well as facilities for tennis, volleyball, horseshoes and other games.

Development Program

Itemized development costs for each activity area are shown in Table 1. Anoka County's five year Capital Improvements Program is attached as Appendix C.

Operations and Maintenance

Fire and police protection will be negotiated on a fee-for-service basis with the City of Fridley. Tree disease control will be a joint effort of the Anoka County Parks Department and the local tree inspector. ←

All routine grounds keeping will be performed by the Anoka County Parks Department. ←

The County Park and Recreation Department does not expect to provide scheduled recreational activities at the park. The ballfields, picnic grounds, and other activity areas will be available for use by athletic associations, clubs, and other civic groups on a reserved scheduled basis. The Islands of Peace Foundation has been requested to continue to provide special program activities for the disabled. The Foundation is expected to continue to concentrate its activities in the Islands of Peace area.

How reserved?

Costs to County for annual operations and maintenance activities have been estimated on Table 2.

TABLE 1
MISSISSIPPI-ISLANDS OF PEACE, DEVELOPMENT PROGRAM

Activity Area	Estimated Development Cost	
FMC PROPERTY		
Roadways	0.75 mile, blacktopped	\$ 72,000
Parking Lots	3 paved lots, 50 vehicles total	21,000
Field Games & Play Equipment	Site Preparation and equipment	5,000
Multi-purpose Trail	1.5 miles, paved	65,250
Scenic Overlooks	4 sites	20,000
Restrooms	1 structure	35,000
Picnic Area	20 table and grills	4,400
Shelters	Two 24' x 40' shelters	6,000
Signs	Entrance and trail signs	2,000
Bicycle Racks	Two racks	500
Lighting	Along roadway and picnic area	5,000
Landscaping	Plantings	5,000
		<u>\$241,150</u>
	Fees and Contingency	<u>8,850</u>
	Subtotal	\$ 250,000
ISLANDS OF PEACE		
Parking Lot		30,000
Picnic	25 tables and grills	5,000
Bridge	Service road to Chase's Island	90,000
Fishing Piers	5 piers	7,000
Boat Launch	Launch on Chase & beach on Durnam	5,000
Boat Dock	On Durnam Island	1,200
Water Supply	Provide connection to Chase Island	10,000
Reception Center	1,440 sq. ft. expansion	87,000
Trails	3.6 miles, paved	162,000
		<u>\$ 397,200</u>
	Fees and Contingency	<u>76,800</u>
	Subtotal	\$ 474,000
CONNECTING TRAIL*		
Multi-purpose Trail	0.3 miles, paved	13,500
I-694 Underpass	trail support, safety fence	75,000
Public Access		12,000
		<u>\$100,500</u>
	Fees and Contingency	<u>12,000</u>
	Subtotal	<u>\$112,500</u>
	GRAND TOTAL	\$836,500

*Regional funds will also be requested in the future to enable connections with the Rice Creek, Coon Rapids Dam, and north Minneapolis segments of the Regional Trail System.

TABLE 2
 MISSISSIPPI-ISLANDS OF PEACE, ANNUAL OPERATIONS PROGRAM

Activity	Estimated 1980 Operations/Maintenance Cost
Full-time Junior Parkkeeper	\$ 17,200
Seasonal Park Worker (4 months)	2,500
Garbage Collection (Twice weekly)	2,000
14 Security Lights	1,300
Electricity for Restrooms	200
Landscaping and Lawn Care	1,000
Police Patrols*	3,400
Miscellaneous Repairs	3,000
Water and Sewer	2,000
Maintenance for Islands of Peace Reception Center	12,000
Part-time staff for Reception Center	<u>7,000</u>
Total	<u>\$ 51,600</u>

*During the 6 month summer season, the park will be patrolled for 4 hours of each day; during the remainder of the year the patrol schedule will be reduced to 12 hours per week.

APPENDIX A

Correspondence

Department of Natural Resources
Department of Transportation

November 14, 1979

Mr. Chuck Weischselbaum
District State Aid Engineer
Minnesota Department of Transportatin
Golden Valley, Minnesota

Dear Mr. Weischselbaum:

We are writing as representatives of the Anoka County Park and Recreation Department in regard to two proposed trail corridors: the Rice Creek West Regional Trail and the trail connecting the FMC and Islands of Peace properties along the east side of the Mississippi River. Basically, we are writing to see if MN DOT would agree in concept to the proposed routings of these corridors under T.H. 65 in Fridley and under the I-694 underpass.

We are under contract with the Anoka County Park and Recreation Department to assist them in preparing master plans for the Rice Creek West Regional Trail and the FMC Islands of Peace Regional Park. The master plans must be reviewed and approved by the Metropolitan Council in order for the County to take advantage of funds programmed for the facilities. The County is seeking to have the plans completed by November 30th.

Enclosed are maps and photographs of the two areas. A brief description of each proposal follows.

Rice Creek West Trail

The proposed trail route calls for the bike and hike trail to pass under Trunk Highway 65 through one of the two existing culverts accomodating the Rice Creek flow. The County proposes to use a catwalk bridge within the culverts.

FMC - Islands of Peace

The proposed trail would link the Islands of Peace Park with the FMC riverfront property that is to be acquired. The trail would follow the east riverbank behind the Georgetown Apartments and pass under the I-694 bridge. The trail would probably require some sort of bridge to maintain a corridor during fluctuating water levels. (NOTE: The County submitted a PDR for Great River Road funds involving the FMC portion of this area in September, 1979.)

Please review these trail concepts and let us know the degree to which some sort of cooperative arrangement between MN DOT and Anoka County can be worked out. Also, please let us know of any special design or use considerations that you feel would be necessary toward reaching an agreeable plan.

Again, at this point we would like to develop a memorandum of understanding that the trail routes are acceptable and that MN DOT and Anoka County can work together to reach an agreement on details of engineering, construction materials, etc. as well as an easement for trail use. Please feel free to call us if you have any questions.

Sincerely,



Mary Ellen Ordal
Associate

MEO:cal
Enclosures

cc to Dave Fortildson
Anoka Co. Parks



Minnesota
Department of Transportation
District Five
5801 Duluth Street
Golden Valley, Minnesota 55422

(612) 545-3761

December 17, 1979

Ms. Mary Ellen Ordal, Associate
Barton-Aschman Associates, Inc.
Ten Cedar Square West/Cedar-Riverside
1610 South Sixth Street
Minneapolis, Minnesota 55404

SP 0285 T.H. 694

SP 0207 T.H. 65

Review of Proposed Trail crossings on T.H. 694
under Mississippi River Bridge and on T.H. 65
at Rice Creek

Dear Ms. Ordal:

Your letter of November 15 to Mr. Weichselbaum in regard to the above referenced project has been referred to this office for response. We are sorry we were unable to respond by November 30th but due to the number of offices involved, it usually takes four to five weeks to review such a request.

We agree in concept to the proposed trail crossings. However, there will be some conditions to these crossings which will be included in a permit which must be obtained from our district office before the crossings can be constructed.

In regard to the proposed Rice Creek West Trail under TH 65 through one of the existing culverts, our District Hydraulics Engineer, Mr. John Boynton, will need answers to the following questions before approval:

- What effect will there be on the hydraulic capacity of the box culverts?
- Will the design cause debris to lodge in the culvert?
- A flood insurance study for the city of Fridley is currently under preparation. Will this proposal have any effect on this study?
- Who would have the maintenance and liability for the catwalk bridge inside the culvert?

We will be interested in what type of funds are to be used for construction of the trail. If Land and Water Conservation (LAWCON) funds are to be used, we will have to include specific conditions as part of our permit to avoid any future conflicts should the trail have to be modified due to future highway construction. At the present time no future construction is anticipated on TH 65; however, we do anticipate some construction on 694.

Ms. Mary Ellen Ordal, Associate

December 17, 1979

Page 2

After you develop preliminary plans at each location we will be able to give you more specific comments about the design details. If you need additional information or have any questions in regard to the above comments, please feel free to call me.

Sincerely,

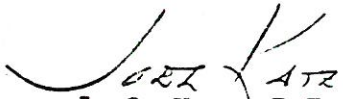
A handwritten signature in cursive script, appearing to read "J. S. Katz".

J. S. Katz, P.E.
Layout, Research &
Development Engineer

JSK:bn

December 3, 1979

Mr. Kent Lokkesmoe
Regional Hydrologist
Minnesota Department of Natural Resources
1200 Warner Road
St. Paul, Minnesota 55106

Dear Mr. Lokkesmoe:

We are writing as representatives of the Anoka County Park and Recreation Department in regard to two proposed trail corridors: the Rice Creek Regional Trail and the trail connecting the FMC and Islands of Peace properties along the east side of the Mississippi River (Mississippi Islands of Peace Regional Park). Basically, we are writing to see if Mn DNR would agree in concept to the proposed routings of these corridors as they relate to natural resource concerns.

We are under contract with the Anoka County Park and Recreation Department to assist them in preparing master plans for the Rice Creek Regional Trail and the Mississippi Islands of Peace Regional Park. The master plans must be reviewed and approved by the Metropolitan Council in order for the County to take advantage of funds programmed for the facilities. The County is seeking to have the plans completed as soon as possible.

As part of the development plan process, we are seeking an indication of your acceptance of the trail corridor concept. Prior to any construction, details on engineering, construction materials etc. regarding the trail will have to be worked out with the agencies involved, including the DNR.

Enclosed are maps and photographs of the two areas. A brief description of each proposal follows. In particular, there are several items the DNR may wish to consider in their review:

RICE CREEK REGIONAL TRAIL

1. General use of the Rice Creek Corridor for recreational purposes.
2. Where necessary to support a trail in low and marshy areas, some boardwalk and/or bridge construction will be needed. Proposed boardwalks will be 4-8 feet wide fir framed, cedar decked with styrafoam flotation. Bridges will be steel and wood structures designed to accomodate bicycles and pedestrains. Three bridges will be for pedestrain use, two for bicycles and four for combined pedestrain and bicycle use. In the Ramsey County section of the trail, two trestle-type bridges will be needed to provide crossing over the Spring Creek Channel and over Rice Creek immediately north of Long Lake.

3. The County proposes a trail crossing of T.H. 65 via use of a catwalk bridge within one of the existing twin culverts accomodating the Rice Creek flow under the highway.
4. The County proposes restoration of the small dam on Rice Creek to create a ponding area behind the dam (for wildlife habitat) and to help maintain an adequate water level downstream for canoeing.

MISSISSIPPI - ISLANDS OF PEACE REGIONAL PARK

1. The proposed trail would link the Islands of Peace Park with the FMC riverfront property that is to be acquired. The trail would follow the east riverbank behind the Georgetown Apartments and pass under the I-694 bridge. The trail would probably require some sort of bridge to maintain a corridor during fluctuating water levels.
2. A service bridge is proposed to connect Chases's Island to the shoreline. The bridge would provide access for walkers and wheelchair bound users to the island, where five fishing piers and other recreational facilities will be developed. Three smaller bridges would be needed at the north and south ends of the island to accomodate pedestrians.

Please review the trail and park concepts and let us know the degree to which some sort of cooperative arrangement between the DNR and Anoka County can be worked out. Also, please let us know of any special design, use or policy considerations that you feel would be necessary toward reaching an agreeable plan.

Again, at this point we would like to develop a memorandum of understanding or other agreement that the trail routes are acceptable and that the DNR and Anoka County can work together to reach an agreement on details of engineering, construction materials etc. prior to trail construction. Please feel free to call us or Dave Torkildson, if you have any questions.

Sincerely,



Mary Ellen Ordal
Associate



William F. Short
Senior Associate

MEO, WFS:cal
Enclosures

cc: Dave Torkildson
Anoka County Park and Recreation Dept.



STATE OF
MINNESOTA
 DEPARTMENT OF NATURAL RESOURCES
 Metro Region Waters, 1200 Warner Road, St. Paul, MN 55106

PHONE: 296-7523

File No. _____

January 2, 1980

Mary Ellen Ordal
 Barton-Aschman Associates, Incorporated
 Ten Cedar Square West/Cedar-Riverside
 1610 South Sixth Street
 Minneapolis, Minnesota 55404

RE: RICE CREEK REGIONAL TRAIL AND ISLANDS OF PEACE REGIONAL PARK

Dear Ms. Ordal:

The Regional Waters Office and the Regional Trail and Watercourses Coordinator have reviewed your trail plan and we can generally support the concept you presented; however, several items should be discussed in more detail. The Mississippi River, Rice Creek, and Locke Lake are public waters and permits will be needed to alter them and to construct the proposed crossings. Hydraulic data will have to be provided to document that the bridge within the TH 65 culverts doesn't impede the design flow of the culverts.

Rice Creek Regional Trail-Also, easements may be necessary from the Highway Department and from Burlington Northern for the trails through or under their crossings. The proposed dam will be reviewed by our wild-life personnel and depending on design heights and storage volumes, the dam may require review by our dam safety section.

Islands of Peace Regional Park-The above comments regarding hydraulic analysis and obtaining the necessary easements would apply..

It is not the general policy of the Department of Natural Resources (DNR) to allow the construction of bridges to islands; however, in this case, with an existing bridge to the island and proper design considerations (i.e., flooding and navigation) I feel the bridges may be permitted.

The Department is willing to work with the County and yourselves to reach a cooperative agreement regarding your proposals and it would be desirable to review your proposal in the field to reach a better understanding of what is proposed.

Please contact me at your convenience to set up a meeting.

Sincerely,

 Kent Lokkesmoe

Regional Hydrologist

KL/ch

cc: Delos Barber, Regional Trails and Waterway Coordinator
 Dave Torkildson, Anoka County Parks

APPENDIX B

Parcel Descriptions

FMC Property
Hayes Lots
Durnam Island

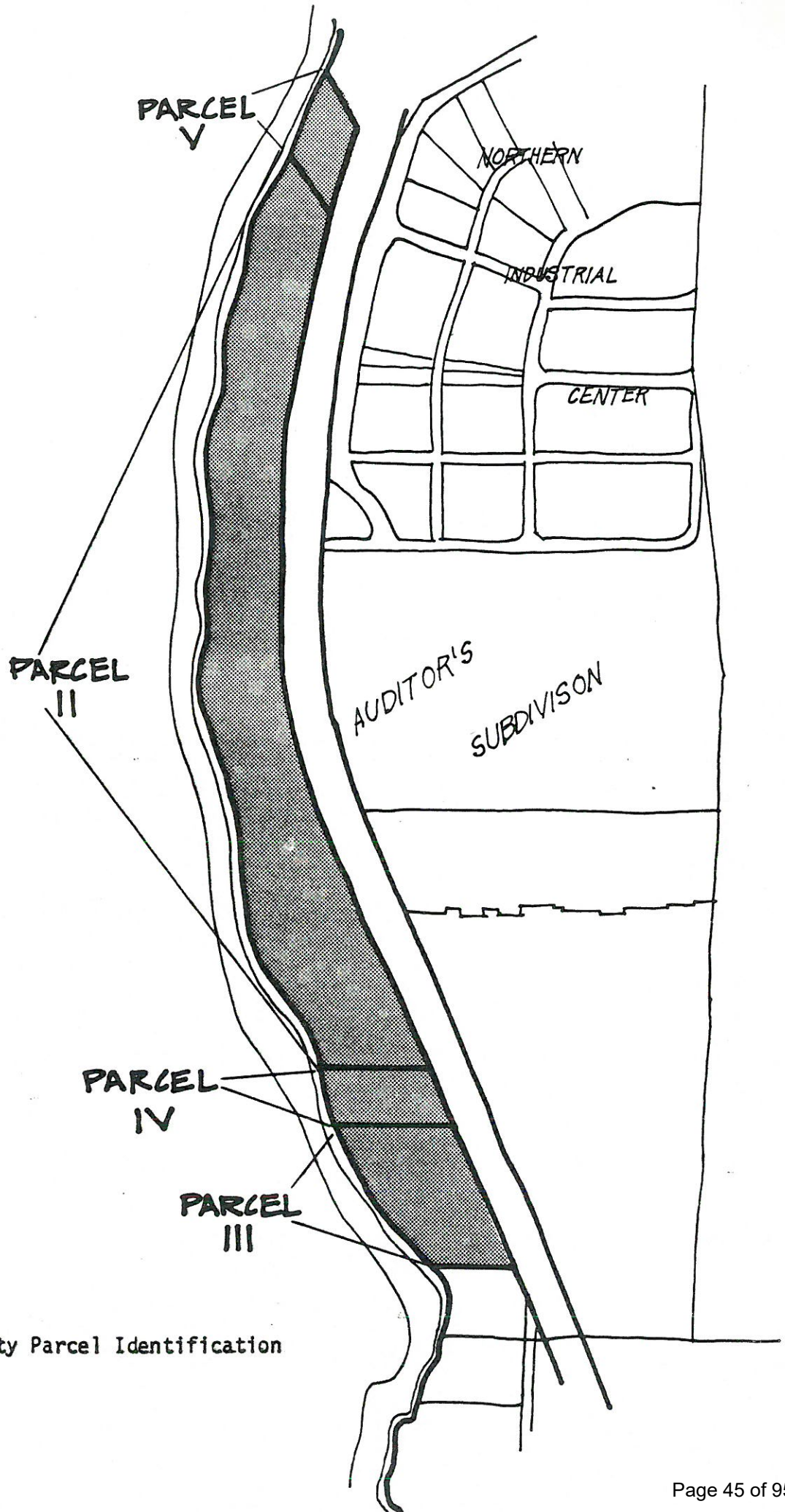

F.M.C. Property Parcel Identification

PARCEL II
Parts of Sections Twenty-two (22) and Twenty-seven (27), Township Thirty (30), Range Twenty-four (24), Anoka County, Minnesota, described as follows: From a point on the south line of Section Thirty-four (34), Township Thirty (30), Range Twenty-four (24), in said County, distant 512.7 feet east of the south quarter corner of said Section, thence run northeasterly at an angle of 80°43'30" with said south section line for 289.1 feet; thence deflect to the left at an angle of 5°37' for 4225.98 feet; thence deflect to the left at an angle of 26°54' for 4272.65 feet; thence deflect to the right at an angle of 28°00' for 1626.4 feet; thence deflect to the right on a ten chord spiral curve of decreasing radius, spiral angle 1°07'30" for 150 feet; thence deflect to the right on a 1°30' circular curve, delta angle 15°17' for 912.9 feet, thence run northwesterly at an angle of 45°00' with the tangent to the curve at said point to the point of intersection, marked by a Judicial Landmark, with the westerly line of the right of way of Anoka County Highway No. 1, as said highway is laid out and established by a Judicial Landmark, which said point is the true point of beginning of the lands to be described; thence continuing northwesterly on the extension of said last described course 373 feet to a Judicial Landmark at the top of the east bank of the Mississippi River; thence continuing northwesterly on an extension of said last described course 55 feet, more or less, to the shore of said river; thence southerly along the said shore of said river to the point of intersection with the south line of Government Lot Three (3) in said Section Twenty-seven (27), said south line of said Lot Three (3), being marked by two Judicial Landmarks on said line, one at the point of intersection with the westerly line of said highway right of way and one distant 511.85 feet west of the last identified Judicial Landmark; thence east along the said south line of said Lot Three (3) to the Judicial Landmark at the intersection of the said south line with the westerly line of said highway right of way; thence northerly along the westerly line of said highway right of way to the point of beginning.

PARCEL III

Lot Eleven (11), Auditor's Subdivision Number Seventy-nine (79), Anoka County, Minnesota, according to the plat thereof on file and of record in the office of the Register of Deeds of said County, the north line of which Lot is marked by two Judicial Landmarks on said line, one at the point of intersection thereof with the westerly side of the right of way of Anoka County Highway No. 1, as laid out and established in a northerly and southerly direction, and one near the east shore of the Mississippi River and 519.2 feet west of said first identified Judicial Landmark, and the south line of which is marked by two Judicial Landmarks on said line, one which is offset 3.0 feet west of the point of intersection thereof with the westerly side of said highway right of way and one near the east shore of said river and 457.5 feet west of said Judicial Landmark which is so offset at the intersection of said south line with the westerly side of said highway right of way.

PARCEL IV

That part of Government Lot Four (4), Section Twenty-seven (27), Township Thirty (30) North, Range Twenty-four (24) West, described as follows: Commencing at the point in the North line of Government Lot Four (4) where the said North line is intersected by the Easterly shore of the Mississippi River; thence East along the North line of Government Lot Four (4) to the center line of the Old Military Road a distance of Seven Hundred Thirty-six (736) feet, more or less; thence Southeasterly along the center line of the said Old Military Road a distance of Three Hundred Sixteen (316) feet; thence West parallel with the North line of said Government Lot Four (4) to the East shore of the Mississippi River a distance of Seven Hundred Forty (740) feet, more or less; thence Northerly along the Easterly shore of the Mississippi River a distance of Three Hundred Sixteen (316) feet, more or less, to the point of beginning, said property being also described as Lot Twelve (12), Auditor's Subdivision No. Seventy-nine (79), according to the plat thereof on file and of record in the Register of Deeds' office in and for Anoka County, Minnesota.

PARCEL V

ALL that part of Government Lot Four (4), Section Twenty-two (22), Township Thirty (30), Range Twenty-four (24), Anoka County, Minnesota, which lies within the following four lines:

1. From a point on the South line of Section Thirty-four (34), Township Thirty (30), Range Twenty-four (24) in said County, distant Five Hundred Twelve and Seven-tenths (512.7) feet East of the South quarter corner of said Section; thence run Northeasterly at an angle of Eighty degrees Forty-three minutes Thirty seconds (80°43'30") with said South section line for Two Hundred Eighty-nine and one-tenth (289.1) feet; thence deflect to the left at an angle of Five degrees Thirty-seven minutes (5°37') for Four Thousand Two Hundred Twenty-five and Ninety-eight hundredths (4225.98) feet; thence deflect to the left at an angle of Twenty-six degrees Fifty-four minutes (26°54') for Four Thousand Two Hundred Seventy-two and Sixty-five hundredths (4272.65) feet; thence deflect to the right at an angle of Twenty-eight degrees zero minutes (28°00') for One Thousand Six Hundred Twenty-six and Four-tenths (1626.4) feet; thence deflect to the right on a ten chord spiral curve of decreasing radius, spiral angle One degree Seven minutes Thirty seconds (1°07'30") for One Hundred Fifty (150) feet; thence deflect to the right on a One degree Thirty minute (1°30') circular curve, delta angle Fifteen degrees Seventeen Minutes (15°17') for Nine Hundred Twelve and nine-tenths (912.9) feet; thence run Northwesterly at an angle of Forty-five degrees zero minutes (45°00') with the tangent to the curve at said point to the intersection, marked by a Judicial Landmark, with the Westerly line of the right of way of Anoka County Highway No. 1, as said right of way is laid out and established in a Northerly and Southerly direction, which intersection is the point of beginning of the line to be described; thence continuing Northwesterly on an extension of said last described course, Three Hundred Seventy-three (373) feet to a Judicial Landmark at the top of the East Bank of the Mississippi

River; thence continuing Northwesterly on an extension of said last described course Fifty-five (55) feet, more or less, to the East shore of the Mississippi River.

2. The Easterly shore of the Mississippi River.

3. From a point on the East line of Section Twenty-two (22), Township Thirty (30), Range Twenty-four (24), distant One Thousand Five Hundred Twenty-eight and Six-tenths (1528.6) feet North of the Southeast corner thereof, run Northwesterly at an angle of Eighty-six degrees Twenty-eight minutes (86°28') with said East section line for One Thousand Seven Hundred Eighteen and Nine-tenths (1718.9) feet; thence deflect to the left at an angle of Ninety degrees zero minutes (90°00') for Seventy-five (75) feet; thence deflect to the right at an angle of Sixty-seven degrees Thirty-five minutes (67°30') for Three Hundred Forty (340) feet; thence deflect to the left at an angle of Thirteen degrees Forty-five minutes (13°45') and run Southwesterly for Nine Hundred Forty-two (942) feet along a line which would intersect a line run parallel with and distant Two Hundred Twenty-five (225) feet Southeasterly of the Northwesterly right of way said tract; thence run Southwesterly to a point on said Two Hundred Twenty-five (225) foot parallel line, distant One Hundred Thirty (130) feet Southwesterly of the above mentioned intersection; thence run Northwesterly at right angles to said Two Hundred Twenty-five (225) foot parallel line to the Northwesterly right of way line of said public road, which point is the point of beginning of the line to be described; thence deflect to the right at an angle of Forty-three degrees zero minutes (43°00') and run Northwesterly to the East shore of the Mississippi River.

4. The Westerly line of Anoka County Highway No. 1 as said highway is laid out and in place, said described parcel of land being a part of Lot Sixteen (16), Auditor's Subdivision No. 70, according to the plat thereof on file and of record in the office of the Register of Deeds in and for said County.

Together with the rights, titles and interests reserved by the party of the first part (Northern Pump Company) herein in that certain deed dated September 16, 1947, by and between Northern Pump Company, formerly The Northern Pump Company, a Minnesota corporation, the United States of America and Minneapolis, Anoka and Cuyuna Range Railroad Company, a Delaware corporation filed for registration in the office of the Registrar of Titles for Anoka County, Minnesota, September 18, 1947 as Document No. 4717, to the extent that such rights, titles and interests are transferable and to the extent that such rights, titles and interests are presently vested in Northern Pump Company, herein.

There is hereby reserved to party of the first part, (Northern Pump Company) its successors and assigns, for the benefit of the tract of land, herein after called "Benefitted Land", situate in the County of Anoka, State of Minnesota (Being parts of Sections 22, 27 and 34, in Township 30, Range 24) lying within the following lines:

- (1) The Southerly line of State Highway No. 100;
- (2) The Easterly line of Anoka County Highway No. 1;
- (3) The center line of the main track of the Great Northern Railway Company; and
- (4) The center line of the spur track of the Great Northern Railway Company extending from the main track of said railroad to the Filtration Plant of the City of Minneapolis;

excluding therefrom (1) that portion thereof not currently owned by the party of the first part (Northern Pump Company) herein (11) Parcel I of the real estate hereinabove conveyed, the following:

- (a) That portion, hereinafter defined, of the perpetual rights (1) to the joint user of certain storm sewers, (11) to the joint user of a sanitary sewer system up to the aggregate of 50% of the full capacity of the system, and (111) to the joint user of water system up to the aggregate of 50% of the full capacity of the system, which rights were reserved by the party of the first part (Northern Pump Company) herein for the benefit of itself, its successors and assigns, and for the benefit of certain lands therein described in the aforementioned deed dated September 16, 1947, filed for registration in the office of the Registrar of Titles for Anoka County, Minnesota, September 18, 1947, as Document No. 4717. Said portion of each of the perpetual rights shall bear the same ratio to the entire portion of the corresponding reserved perpetual right as the acreage contained in the Benefitted Land bears to the entire acreage of the Benefitted Land and of Parcel I of the real estate hereinabove conveyed.
- (b) The right to install, use, maintain, repair and reconstruct all pipes, manholes and accessories over, under and across Parcel I of the real estate hereinabove conveyed reasonably necessary in exercising rights under reservation (a) above.

CITY

FRIDLEY

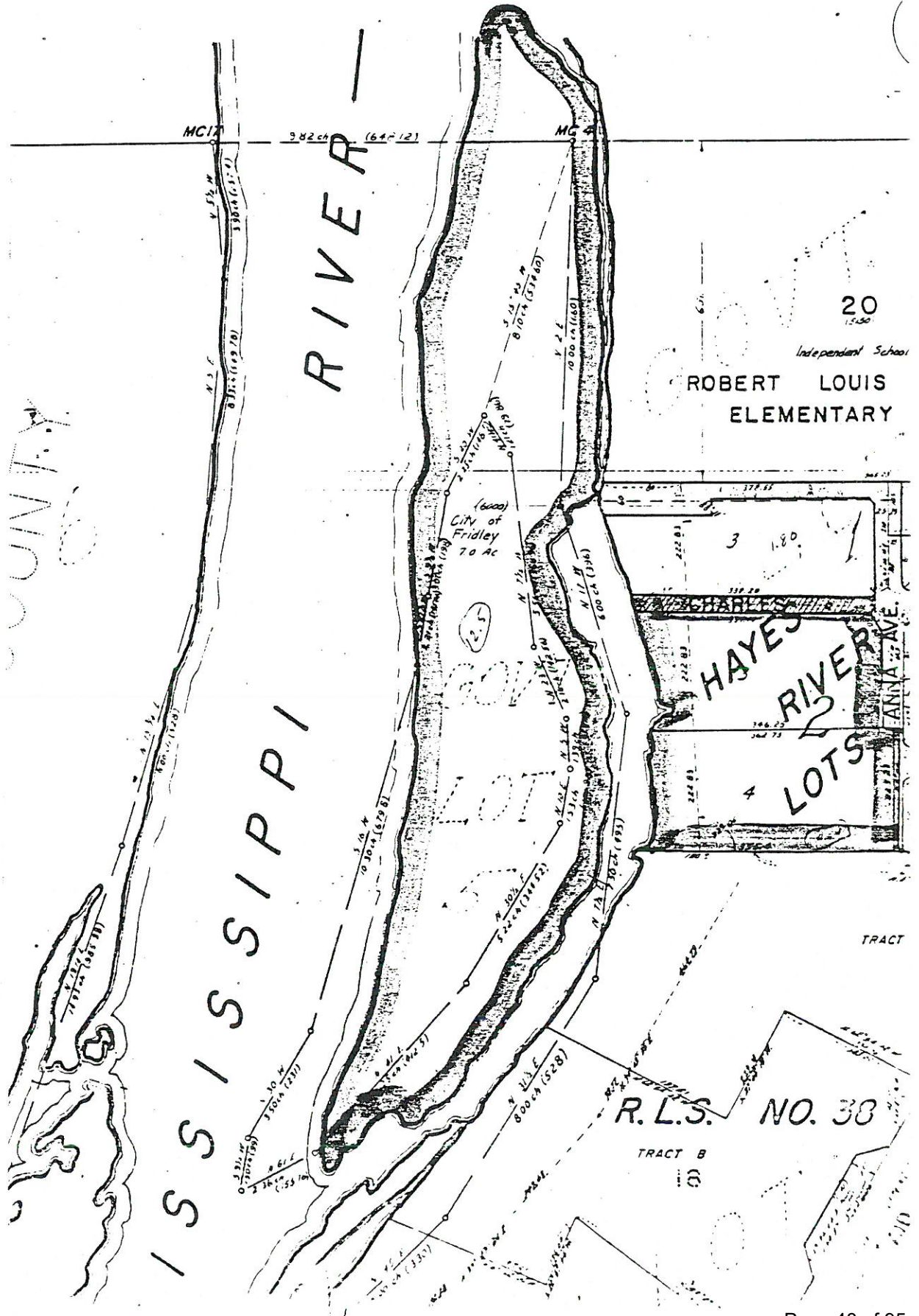

20

Independent School

ROBERT LOUIS
ELEMENTARY

HAYES
RIVER
LOTS

R.L.S. NO. 38

TRACT B

Islands of Peace Park
(Hayes Lots)

City of Fridley
(4.64 acres)

Legal Description:

Lots 3 and 4, Block 2, and vacated Charles Street of
Hayes River Lots, Anoka County, Minnesota.

Islands of Peace Park

(Chase's Island)

City of Fridley

(12.5 acres)

Legal Description:

Government Lot 5, Section 22, Township 30, Range 24,
Anoka County, Minnesota.

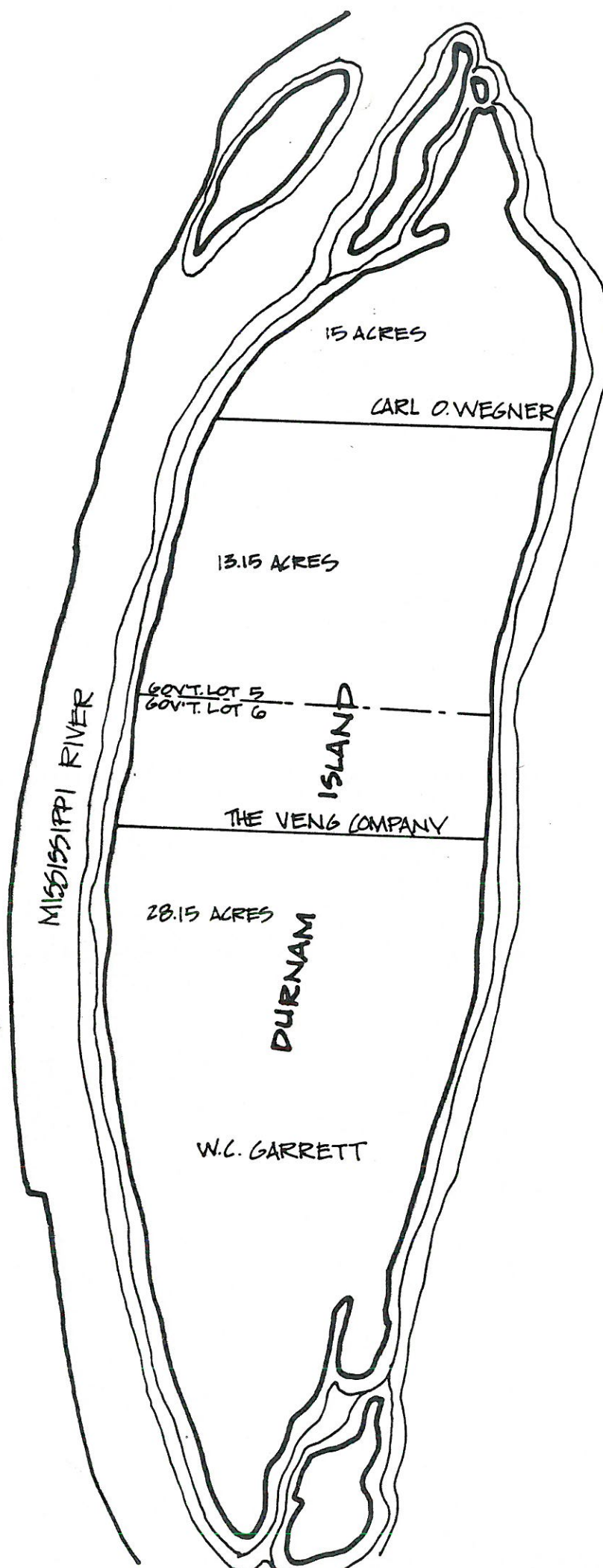

DURNAM ISLAND

(56.30 acres)

Legal Description:

1. The North 15 acres of Durnam Island, except island on North end cut off by high water, being a part of Government Lot 5, Section 15, Township 30, Range 24, Hennepin County, Minnesota.
2. That part of N $\frac{1}{2}$ Durnam Island lying South of the North 15 acres thereof, being a part of Government Lot 5, Section 15, and part of Government Lot 6, Section 22, all in Township 30, Range 24, Hennepin County, Minnesota.
3. The S $\frac{1}{2}$ of Durnam Island being a part of Government Lot 6, Section 22, Township 30, Range 24, Hennepin County, Minnesota.

APPENDIX C
Five Year Capital Improvements Program

OLITAN PARKS AND OPEN SPACE COMMISSION

NG DATA FORM

2. Park Mississippi - Islands of Peace Regional Park

Approved Master Plan Yes No

Acq. Stage Dev. Stage

ire land for park and trail purposes

h a suitable parcel map for acquisition or concept map for development.)

and Maintenance Costs, Use Projections

M	Use	1980			1981			1982			1983			1984-1988		
		Capital	O & M	Use	Capital	O & M	Use	Capital	O & M	Use	Capital	O & M	Use	Capital	O & M	Use
					80,000									
					2,280,000									
					24,000									
					2,384,000											

which capital funding
 al funding will be used:

6. Identify funding sources for O & M costs other than
 general property taxes

Amount Funded by Other Source	Other Source
\$1,767,859.00	Federal Highway
18,000.00	Federal Highway 75% funding

Item #	Total Cost	Amount funded by other than general tax	Other Source
			NONE

ormally adopted CIP for the agency? Yes No

year, etc., please explain the change in status. The new C.I.P. will be approved in December 1979 by
the Anoka County Board of Commissioners. This is
a recent proposed project. See attachments.

9. Authorized Signature *David J. Carlson*

C E R T I F I C A T I O N

I hereby certify that the attached except from the minutes of the Metropolitan Council dated April 12, 1979, is a true and exact copy of the original minutes adopted by the Metropolitan Council on April 26, 1979, which is in the Metropolitan Council files.

Dated this 21st day of May, 1979

Charles R. Weaver, Chairman

1234.2.4 St. Francis FHA Industrial Development Grant, Referral #6782-1
 (Exhibit E) Mrs. Bennett apprised the Council of the committee report. She then moved, seconded by Mr. Scherer:

"That the Council adopt the staff memorandum with the following amended recommendation:

"That the Council find the proposed industrial park consistent with the concept of St. Francis as a proposed Freestanding Growth Center subject to the considerations stated above (in the staff report, page 2). No metropolitan system investments are planned for St. Francis. Any problems arising from the above concerns are solely the community's responsibility. Consistency with Council policies and plans cannot be determined until the community's comprehensive plan is reviewed."

Motion carried.

1234.2.5 Funding of Special Recreation Use Projects (Exhibit F) Mrs. Bennett explained the background on the funding of special recreation use projects to the Council. Mrs. Bennett then summed up the recommendations for the Council, noting especially that recommendation #4 is in relation to the 3rd proposal Council received, which is Islands of Peace. Islands of Peace, she said, would fit into the 4th recommendation. She then moved, seconded by Ms. Campbell, that the Metropolitan Council approve:

- "1. The development stage master plans for Springbrook Nature Center and Noerenberg Garden.
- "2. A development grant of \$365,000 be approved for the Springbrook Nature Center and that the Metropolitan Council enter into an appropriate grant contract with the City of Fridley for the construction of the following:

Visitor Center Building	\$300,000
Parking Lot Expansion	30,000
Trail Development	25,000
Perimeter Plantings	10,000

- "3. A development grant of \$266,400 be approved for the Noerenberg Garden and that the Metropolitan Council enter into an appropriate contract with the Hennepin County Park Reserve District for construction of the following:

Irrigation System	\$110,400
Earth Work	50,000
Retaining Walls	106,000

- "4. Anoka County proceed to prepare a Regional Park Master Plan Amendment to include riverfront properties in the Fridley Area, including: the Hayes lots, Chase Island, Gil Hodges Island, Durnam Island, and the FMC property."

Mr. Ed Wilmes, Senator Schaaf and Mayor Bill Nee all spoke to the Islands of Peace issue, thanking both the Parks and Open Space Commission and the Metropolitan Council for the amount of effort which has been put into this. Senator Schaaf and Mayor Nee said they felt Council had made the right decision and thanked Council for both past and future considerations.

1234.2.6 Centennial School District, Capital Improvement Program, Referral No. 6555-1 (Exhibit G) Mrs. Bennett briefed the Council on the committee report. She called Council's attention to Recommendation #4 which she said she has been advised Centennial has already provided information for and therefore she would not move that recommendation. She then moved, seconded by Mr. Gasper, Recommendations 1-3, that:

METROPOLITAN COUNCIL - METROPOLITAN PARKS AND OPEN SPACE COMMISSION

PITAL IMPROVEMENT PROGRAMMING DATA FORM

Agency Anoka County 2. Park Mississippi - Islands of Peace Regional Park Approved Master Plan Yes No x

Acq. Stage Dev. Stage x

Project Description Develop bike, hike and cross country ski trails along the Mississippi River and hiking trails on Durnam Island. Roads, parking, shelters, water, restrooms, picnic facilities, boat launches, boat docks, fishing piers, walking bridges, overlooks, landscaping and Reception Center addition will all be developed on this site. This Regional Park will eventually be linked to the Minneapolis trail system to the south and Rice Creek West Regional Trail to the north by a multi use trail near East River Road.

Acq. Dev. x

(Attach a suitable parcel map for acquisition or concept map for development.)

Capital Costs, Operations and Maintenance Costs, Use Projections

Design Capacity	1979		1980		1981		1982		1983		1984-1988	
	Capital	Use	Capital	Use	Capital	Use	Capital	Use	Capital	Use	Capital	Use
1. Parkways 3/4mi paved					72,000	...						
1. Parking lot 10/veh.					6,000	...						
1. Parking lot 10/veh.					6,000	...						
1. Parking lot 30/veh.					9,000	...						
1. Field games & Equipment					5,000	...						
1. Bike/Hike Tr. 1.50 mi.					65,250	...						
1. Overlooks-4					20,000	...						
1. Restrooms 235/day					35,000	...						
1. 20 picnic tab. 400/day					4,400	...						
1. Shelters-2 50/day					6,000	...						
TOTALS												

CAPITAL IMPROVEMENT PROGRAMMING DATA FORM

Agency Anoka County 2. Park Mississippi - Islands of Peace Regional Park Approved Master Plan Yes No x

Acq. Stage Dev. Stage x

Project Description

Develop bike, hike and cross country ski trails along the Mississippi River and hiking trails on Durnam Island, Roads, parking, shelters, water, restrooms, picnic facilities, boat launches, boat docks, fishing piers, walking bridges, overlooks, landscaping and Reception Center addition will all be developed on this site. This Regional Park will

Acq. Dev. x

eventually be linked to the Minneapolis trail system to the south and Rice Creek West Regional Trail to the north by a multi use trail near East River Road.

(Attach a suitable parcel map for acquisition or concept map for development.)

Capital Costs, Operations and Maintenance Costs, Use Projections

Description	1979		1980		1981		1982		1983		1984-1988	
	Capital	Use	Capital	Use	Capital	Use	Capital	Use	Capital	Use	Capital	Use
1. Signs					2,000					
2. Bike racks-2		20/time			500	...	14,000					
3. Lighting					5,000					
4. Landscaping					5,000					
5. Fees & Contingency					8,850					
6. 0.3 mi. Hike & bike trails					13,500	15,000					
7. Bike-Hike bridges		75' spar			75,000	...	15,000					
8. Boat launch		25/veh.			12,000	..	6,500					
9. Fees & Contingency					12,000					
10. Parking lot		45/veh.			30,000	...	20,000					
TOTALS												

VITAL IMPROVEMENT PROGRAMMING DATA FORM

Agency Anoka County 2. Park Mississippi - Islands of Peace Regional Park Approved Master Plan Yes No x

Acq. Stage Dev. Stage x

Project Description Develop bike, hike and cross country ski trails along the Mississippi River and hiking trails on Durnam Island, Roads, parking, shelters, water, restrooms, picnic facilities, boat launches, boat docks, fishing piers, walking bridges, overlooks, landscaping and Reception Center addition will all be developed on this site. This Regional Park will eventually be linked to the Minneapolis trail system to the south and Rice Creek West Regional Trail to the north by a multi use trail near East River Road.

Acq. Dev. x

(Attach a suitable parcel map for acquisition or concept map for development.)

Capital Costs, Operations and Maintenance Costs, Use Projections

	Design Capacity	1979		1980		1981		1982		1983		1984-1988	
		Capital	Use	Capital	Use	Capital	Use	Capital	Use	Capital	Use	Capital	Use
Picnic tables & grills-25	400/day					5,000	18,000						
Bridge	1000/day					90,000	15,000						
Fishing piers	5					7,000	1,500						
Boat launch	canoe & pontoon moor					5,000	5,000						
Boat dock	pontoon moor					1,200	1,000						
Water supply	-					10,000	-						
Reception Center	1,440' expansion					87,000	15,000						
Trails	3.6 mi.					162,000	15,000						
Fees & Contingency	-					76,800	-						
TOTAL						836,500							

5. Funding Source

Identify those items for which capital funding sources other than regional funding will be used:

Item #	Total Cost	Amount Funded by Other Source	Other Source
1 - 15	\$250,000	\$187,500	Federal Highway
20 - 29	\$474,000	\$254,009	Great River Road Project

7. Is this project on the formally adopted CIP for the agency? Yes No

If no, or in a different year, etc., please explain the change in status.

The new C.I.P. will be approved in December 1979 by the

Anoka County Board of Commissioners. This is a recent proposed project. See attachments.

6. Identify funding sources for O & M costs other than general property taxes

Item #	Total Cost	Amount funded by other than general tax	Other Source
			NONE

8. Date October 1, 1979

9. Authorized Signature



C E R T I F I C A T I O N

I hereby certify that the attached except from the minutes of the Metropolitan Council dated April 12, 1979, is a true and exact copy of the original minutes adopted by the Metropolitan Council on April 26, 1979, which is in the Metropolitan Council files.

Dated this 21st day of May, 1979

Charles R. Weaver, Chairman

1234.2.4 St. Francis FHA Industrial Development Grant, Referral #6782-1
 (Exhibit E) Mrs. Bennett apprised the Council of the committee report. She then moved, seconded by Mr. Scherer:

"That the Council adopt the staff memorandum with the following amended recommendation:

"That the Council find the proposed industrial park consistent with the concept of St. Francis as a proposed Freestanding Growth Center subject to the considerations stated above (in the staff report, page 2). No metropolitan system investments are planned for St. Francis. Any problems arising from the above concerns are solely the community's responsibility. Consistency with Council policies and plans cannot be determined until the community's comprehensive plan is reviewed."

Motion carried.

1234.2.5 Funding of Special Recreation Use Projects (Exhibit F) Mrs. Bennett explained the background on the funding of special recreation use projects to the Council. Mrs. Bennett then summed up the recommendations for the Council, noting especially that recommendation #4 is in relation to the 3rd proposal Council received, which is Islands of Peace. Islands of Peace, she said, would fit into the 4th recommendation. She then moved, seconded by Ms. Campbell, that the Metropolitan Council approve:

- "1. The development stage master plans for Springbrook Nature Center and Noerenberg Garden.
- "2. A development grant of \$365,000 be approved for the Springbrook Nature Center and that the Metropolitan Council enter into an appropriate grant contract with the City of Fridley for the construction of the following:

Visitor Center Building	\$300,000
Parking Lot Expansion	30,000
Trail Development	25,000
Perimeter Plantings	10,000

- "3. A development grant of \$266,400 be approved for the Noerenberg Garden and that the Metropolitan Council enter into an appropriate contract with the Hennepin County Park Reserve District for construction of the following:

Irrigation System	\$110,400
Earth Work	50,000
Retaining Walls	106,000

- "4. Anoka County proceed to prepare a Regional Park Master Plan Amendment to include riverfront properties in the Fridley Area, including: the Hayes lots, Chase Island, Gil Hodges Island, Durnam Island, and the FMC property."

Mr. Ed Wilmes, Senator Schaaf and Mayor Bill Nee all spoke to the Islands of Peace issue, thanking both the Parks and Open Space Commission and the Metropolitan Council for the amount of effort which has been put into this. Senator Schaaf and Mayor Nee said they felt Council had made the right decision and thanked Council for both past and future considerations.

1234.2.6 Centennial School District, Capital Improvement Program, Referral No. 6555-1 (Exhibit G) Mrs. Bennett briefed the Council on the committee report. She called Council's attention to Recommendation #4 which she said she has been advised Centennial has already provided information for and therefore she would not move that recommendation. She then moved, seconded by Mr. Gasper, Recommendations 1-3, that:

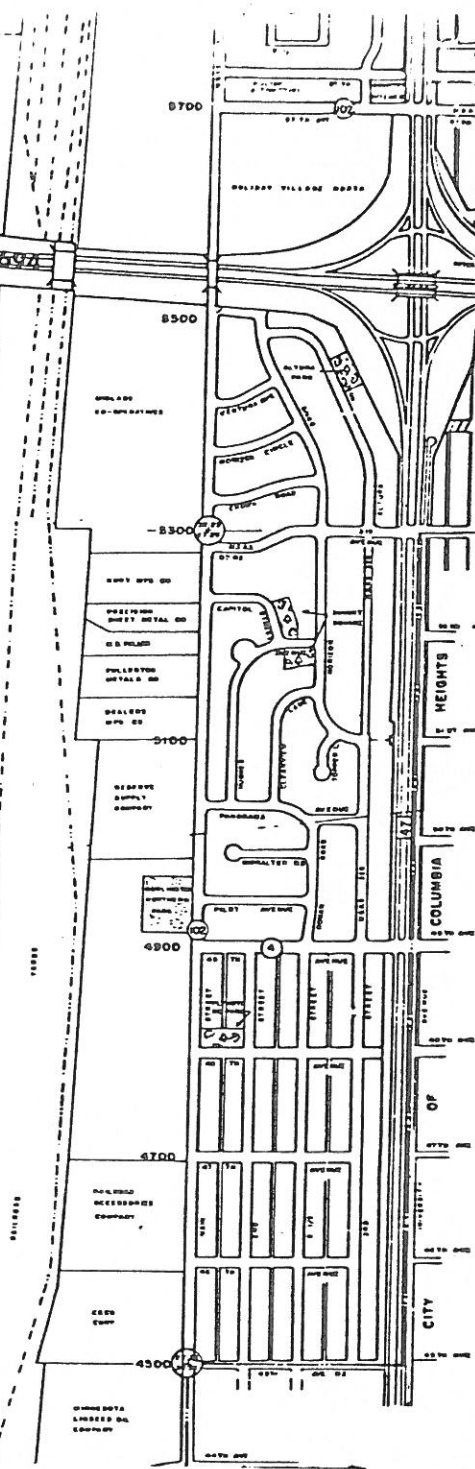
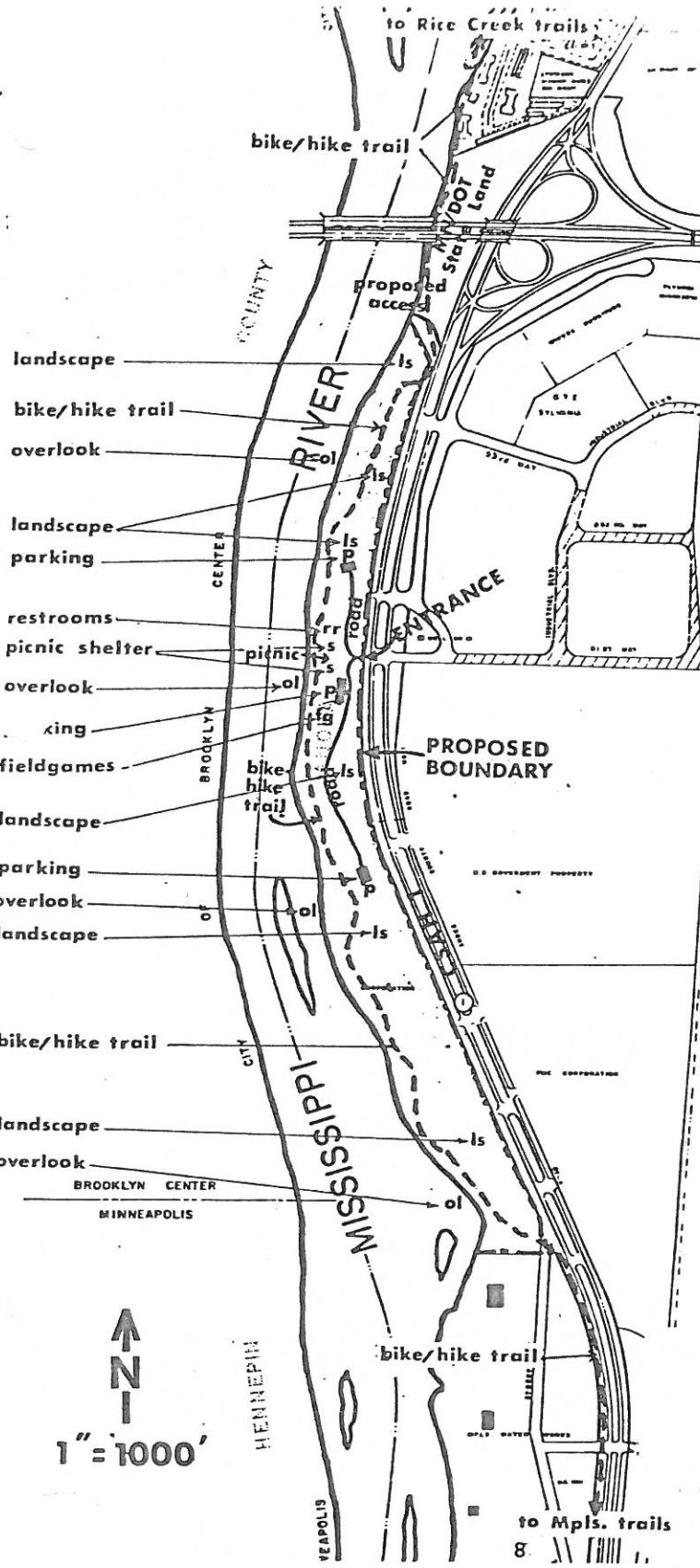

F.M.C Property 52 ac.
Acquisition & Development
Anoka County Parks Dept.
 7-6-79
 Site Plan

↑ N ↓
 1" = 1000'

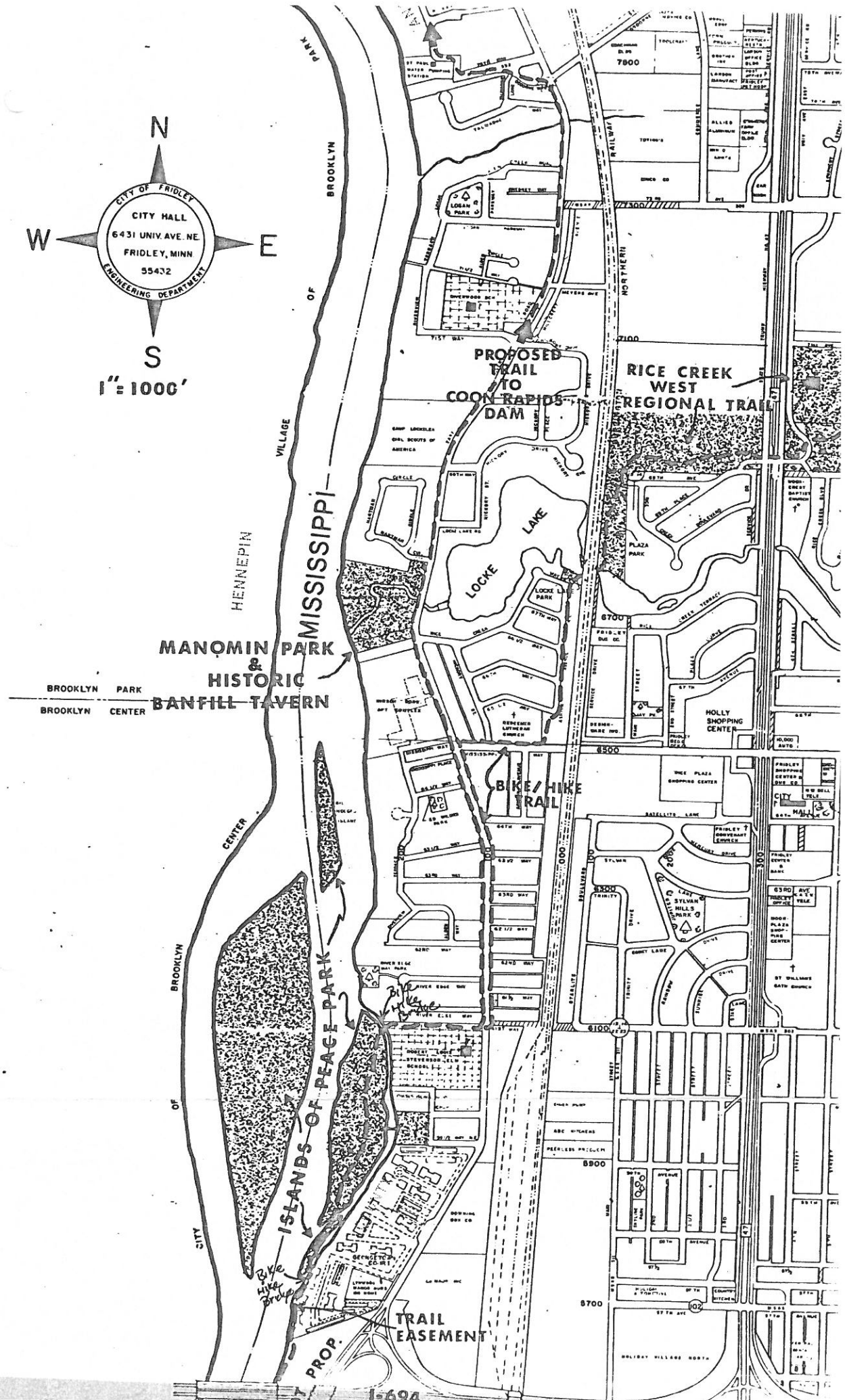
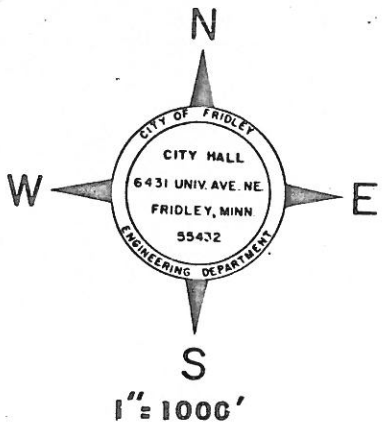

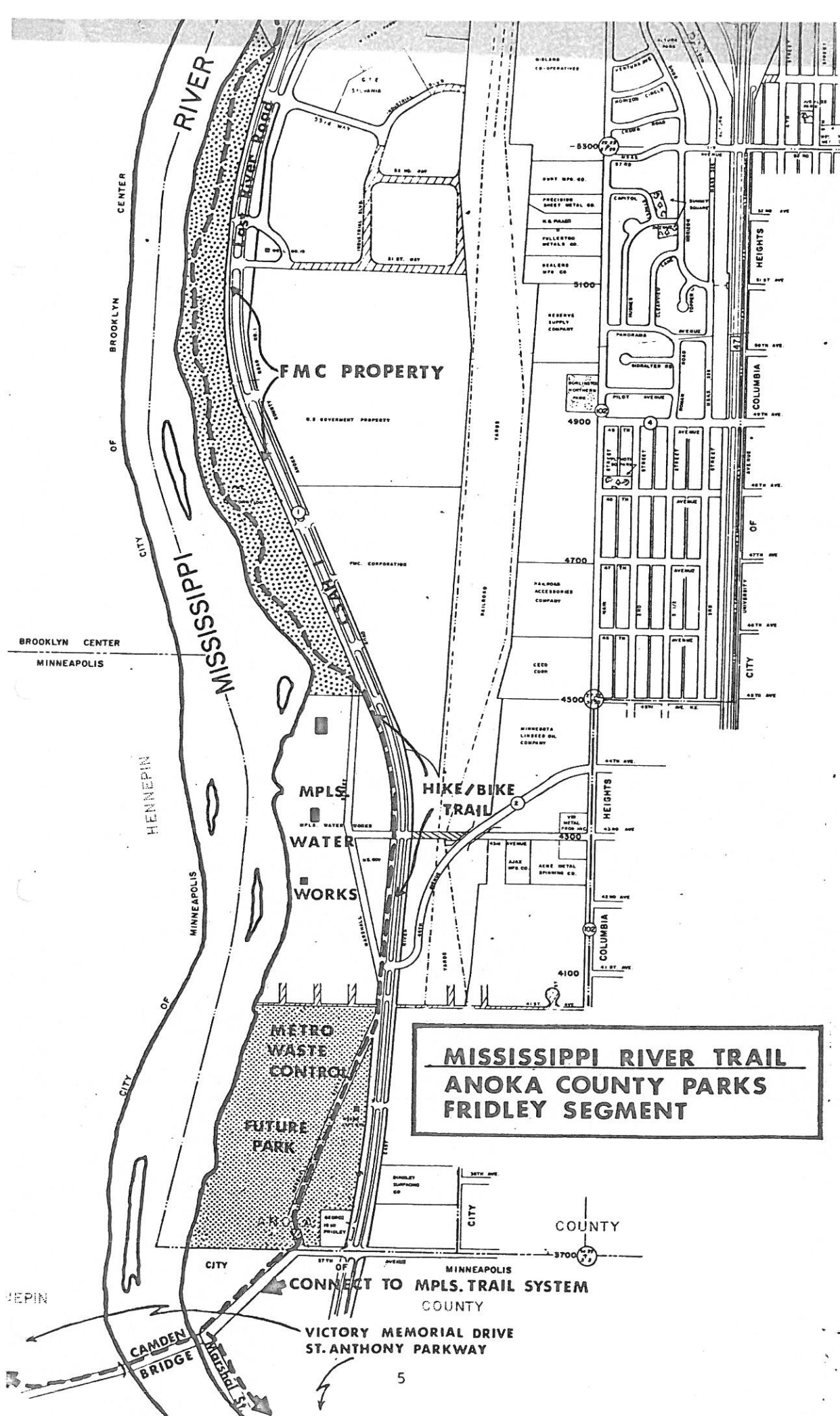

**MISSISSIPPI RIVER TRAIL
ANOKA COUNTY PARKS
FRIDLEY SEGMENT**

CONNECT TO MPLS. TRAIL SYSTEM

VICTORY MEMORIAL DRIVE
ST. ANTHONY PARKWAY

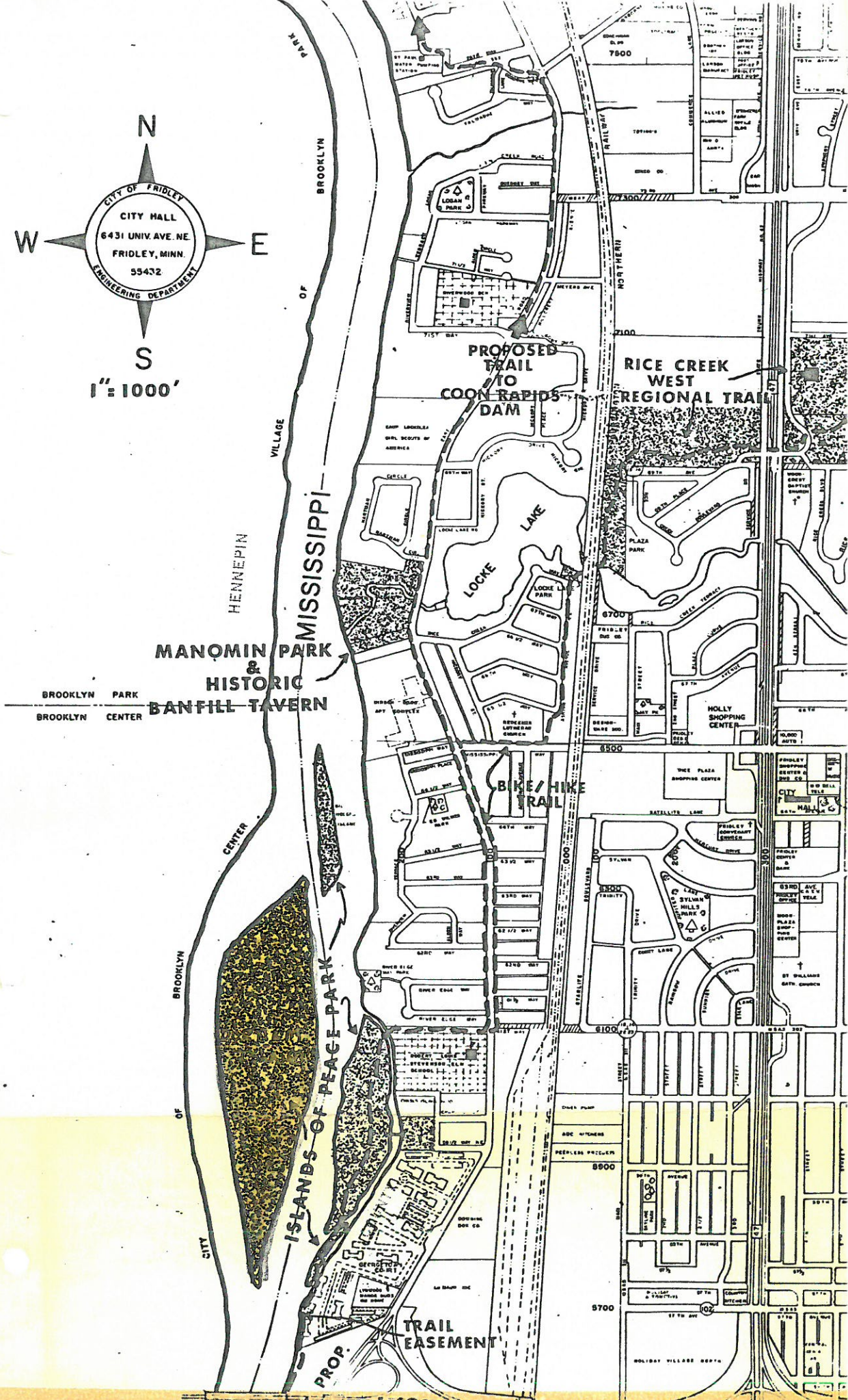
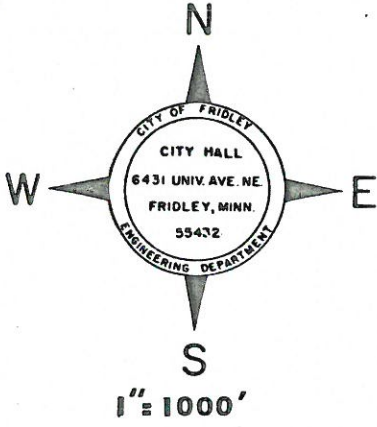

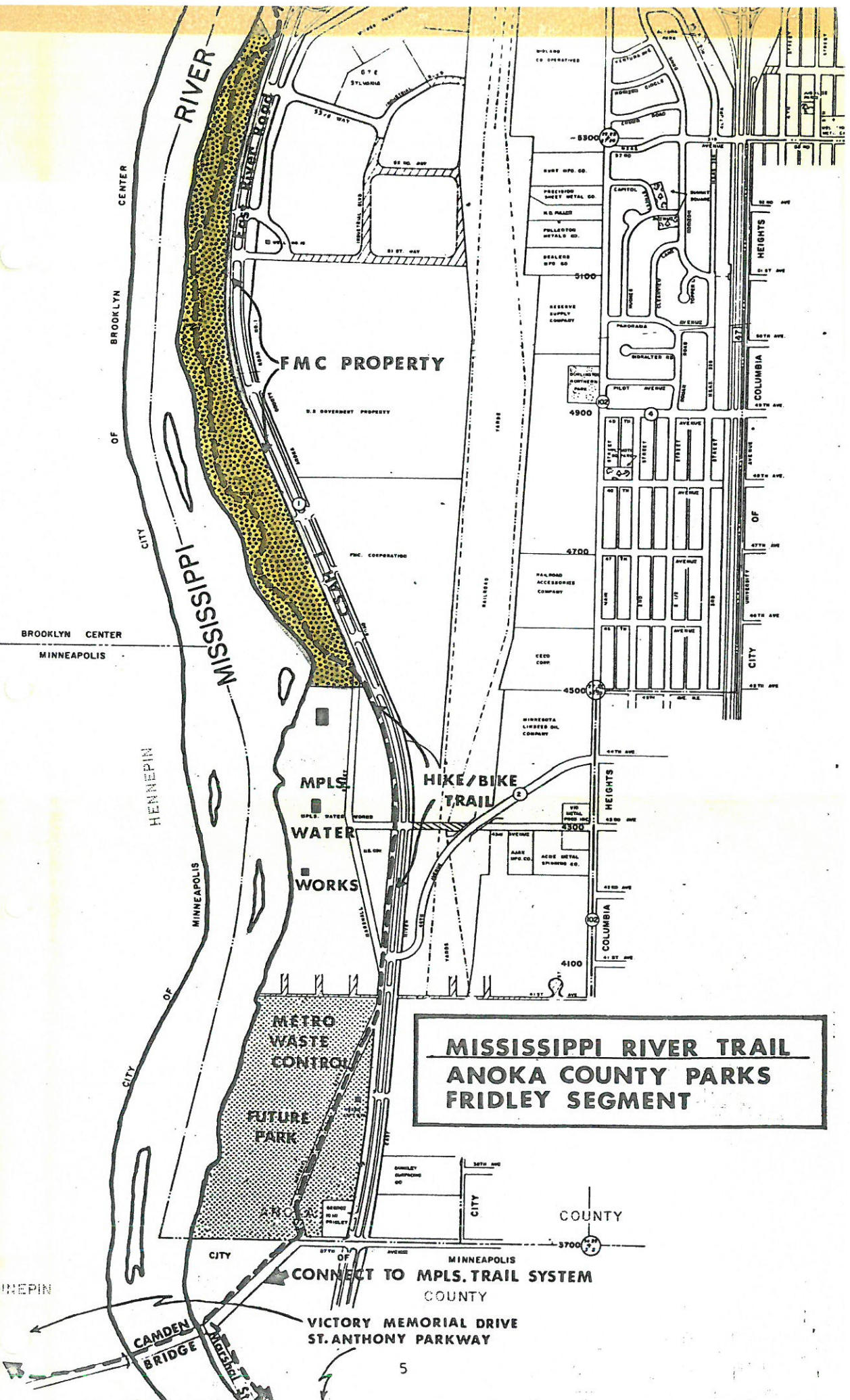

**MISSISSIPPI RIVER TRAIL
ANOKA COUNTY PARKS
FRIDLEY SEGMENT**

CONNECT TO MPLS. TRAIL SYSTEM
VICTORY MEMORIAL DRIVE
ST. ANTHONY PARKWAY

Metropolitan Parks and Open Space Commission

Meeting date: April 7, 2014

For the Community Development Commission meeting of April 21, 2014

For the Metropolitan Council meeting of May 14, 2014

Subject: Anoka County Riverfront Regional Park Master Plan Amendment, Anoka County

District(s), Member(s): MPOSC District A, Rick Theisen

Policy/Legal Reference: MN Statute 473.313

Staff Prepared/Presented: Jan Youngquist, AICP, Planning Analyst (651-602-1029)

Division/Department: Community Development, Regional Parks and Natural Resources

Proposed Action

That the Metropolitan Council:

1. Approve the Anoka County Riverfront Regional Park Master Plan Amendment.
2. Require that prior to initiating development at Anoka County Riverfront Regional Park, preliminary development plans should be sent to Scott Dentz, Interceptor Engineering Manager (651-602-4503) at Metropolitan Council Environmental Services for review in order to assess the potential impacts to the regional interceptor system.
3. Require that once executed, Anoka County should submit to the Metropolitan Council a copy of the Joint Powers Agreement or any subsequent amendments between the County and the City of Fridley that incorporates City-owned land into the regional park boundary and allows the County to operate and maintain the property as regional parkland.

Background

Anoka County Riverfront Regional Park is an existing 140-acre park located along the Mississippi River in Fridley and consists of two park areas that are connected by the Mississippi River Regional Trail. The original master plan for the regional park was approved in 1980 and this master plan amendment updates and expands on that plan. The regional park boundary is proposed to be expanded by approximately 5 acres. A 3.5 acre parcel is owned by the City of Fridley and a 1.5 acre parcel is currently privately owned, but the City is proposing to obtain the land through park dedication when the general area is redeveloped. Both parcels would remain under City ownership; a Joint Power Agreement between Fridley and Anoka County would allow the County to operate and maintain the property as regional parkland. Proposed development described in the master plan includes new picnic pavilions, a disc golf course, a canoe launch, and a playground, as well as parking lot and trail reconstruction.

Rationale

The Anoka County Riverfront Regional Park Master Plan Amendment is consistent with the requirements of the *2030 Regional Parks Policy Plan* and other Council policies.

Funding

The estimated cost to implement the master plan is \$5,300,000 for development. There are no acquisition costs associated with the master plan.

Approval of this master plan makes the acquisition and development costs eligible for regional parks funding, but does not commit the Council to any funding at this time. Future funding based on this master plan may be awarded through the Regional Parks Capital Improvement Program (CIP). Council action is required to approve the CIP and to approve specific grants to Anoka County.

Known Support / Opposition

The Anoka County Board passed a resolution approving the Anoka County Riverfront Regional Park Master Plan Amendment on January 14, 2014. The master plan also includes a resolution of support from the City of Fridley. There is no known opposition to the master plan.

Analysis

The 2030 Regional Parks Policy Plan requires that regional park master plans address the eleven items listed below.

1. **Boundaries and Acquisition Costs:** Anoka County Riverfront Regional Park is located along the Mississippi River in Fridley. The regional park has 140 acres of parkland in two areas that are connected by the Mississippi River Regional Trail. The location of the park is shown in *Figure 1*.

Figure 1: Location of Anoka County Riverfront Regional Park

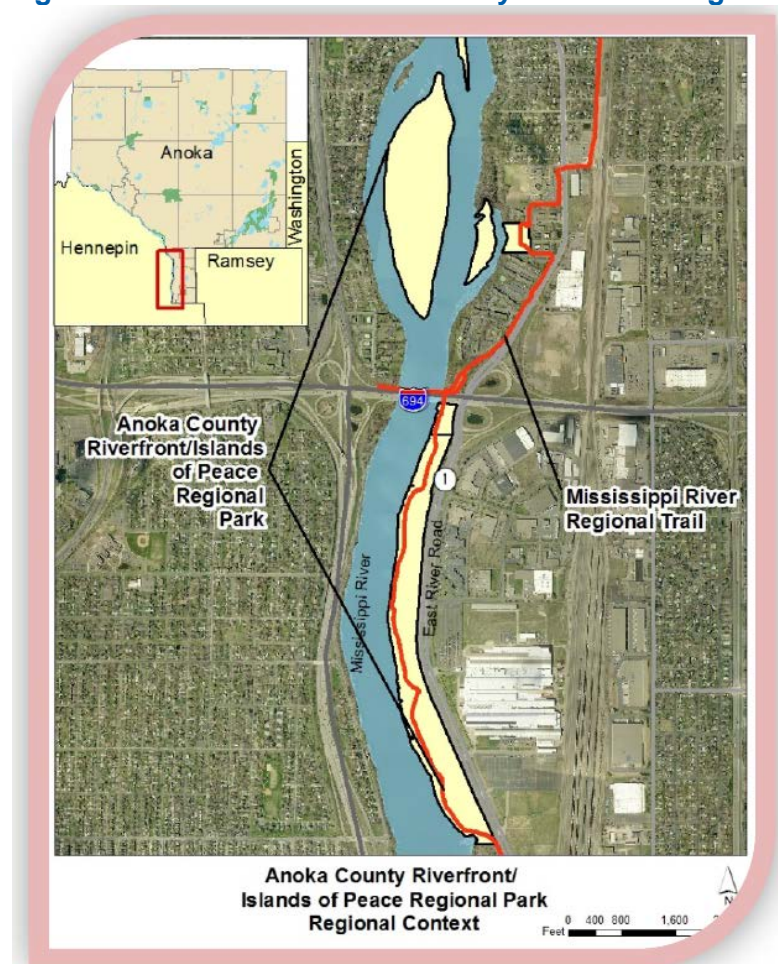

The area north of Interstate 694 (I-694), known as Islands of Peace, consists of 66 acres, including three islands: Chases Island, Durnam Island and Gil Hodges Island. Approximately 10 of the 66 acres are owned by the City of Fridley, but are operated and maintained by Anoka County as regional parkland through a Joint Powers Agreement.

The area south of I-694 is known as Riverfront and consists of 74 acres, including over a mile of river shoreline. A small portion of the park includes public right-of-way for I-694. Anoka County has a Limited Use Permit with the Minnesota Department of Transportation to use the area for park and open space purposes. Currently, the area includes a boat launch, parking lot and small picnic area. The Limited Use Permit states that no permanent structures can be placed in the right-of-way.

The current boundaries of Anoka County Riverfront Regional Park are shown in Figure 2.

Figure 2: Current Boundaries of Anoka County Riverfront Regional Park

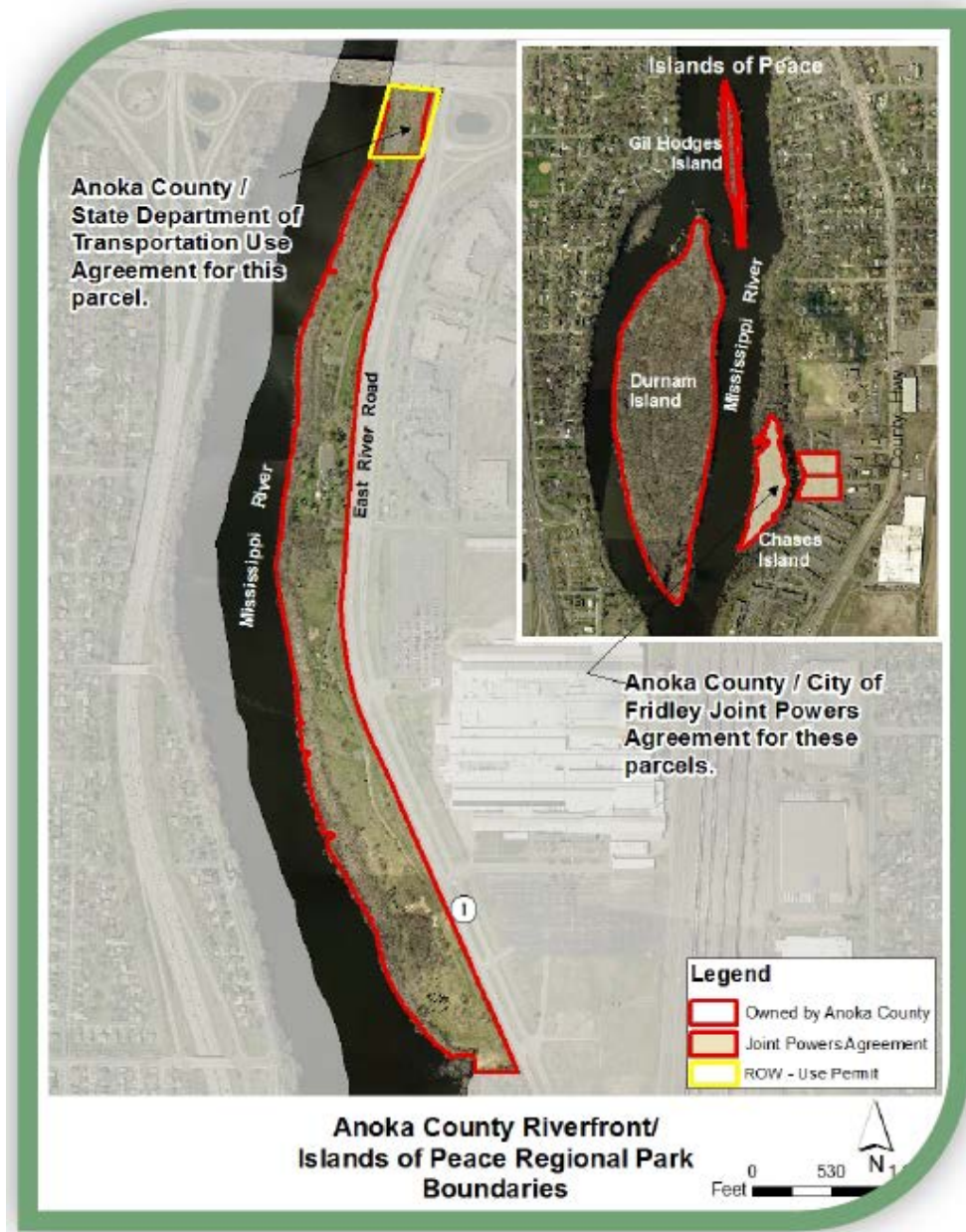

The master plan proposes to expand the boundaries of Anoka County Riverfront Regional Park by adding two parcels totaling approximately 5 acres in the Islands of Peace area. Parcel 1 includes 3.5 acres which are owned by the City of Fridley. Parcel 1 is proposed to be added to the regional park boundary through a revised Joint Powers Agreement, in which the City would retain ownership and the County would operate and maintain it as regional parkland.

Parcel 2 is currently privately owned. The City of Fridley is proposing to acquire approximately 1.5 acres through park dedication when the area is redeveloped as part of the Transit Oriented Development plan for the Northstar Commuter Rail Station. Once this parcel is under City ownership, the Joint Powers Agreement will be amended. The proposed boundary expansion areas are shown in *Figure 3*.

Anoka County does not intend to purchase Parcels 1 or 2. The land would be incorporated into the regional parks system through a Joint Powers Agreement with the City of Fridley. Therefore, there are no acquisition costs associated with the boundary expansion.

Figure 3: Proposed Boundary Expansion of Anoka County Riverfront Regional Park

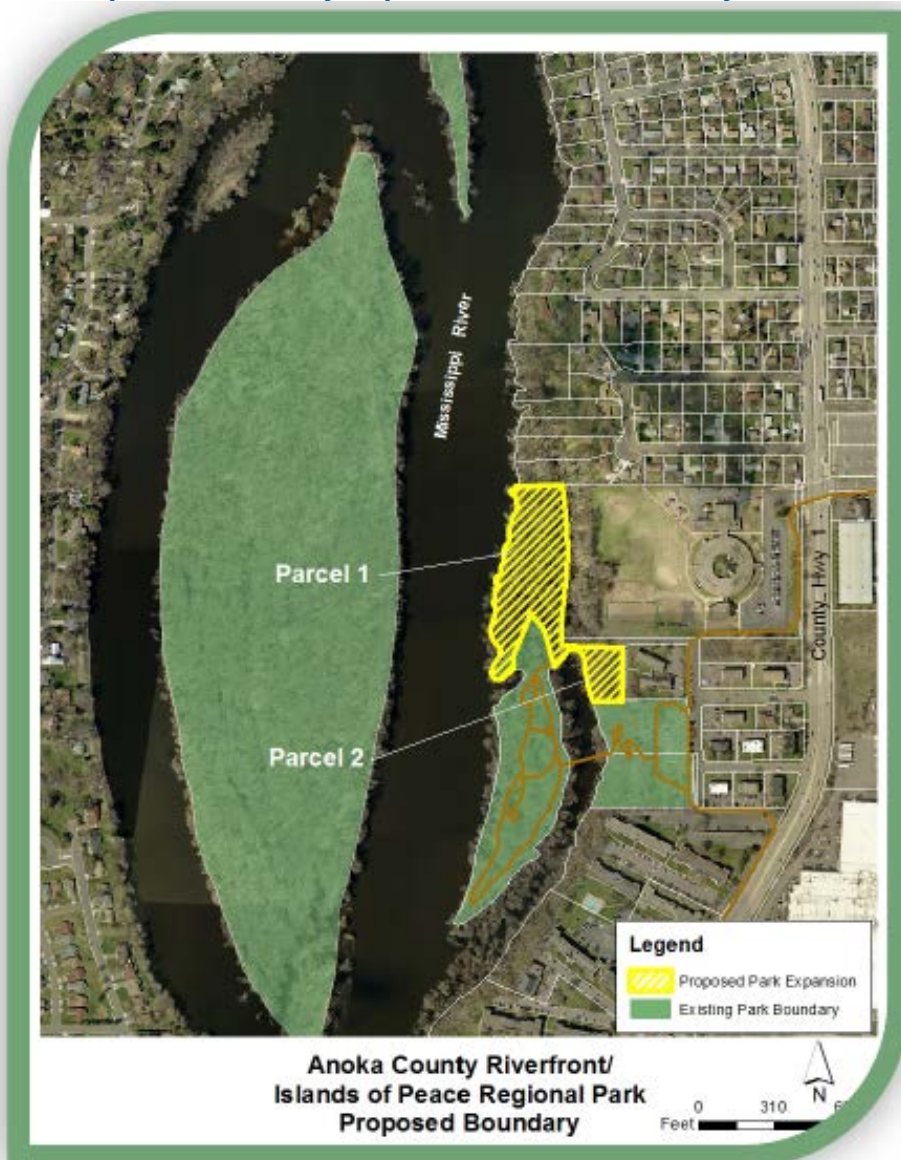

2. Demand Forecast: Anoka County Riverfront Regional Park had an estimated 245,500 visits in 2012. As population grows, the need for additional recreational opportunities and amenities grows as well. Anoka County's population is projected to grow to 437,550 by 2030, which is an 18 percent increase from 2010. The City of Fridley has a Transit Oriented Development plan for the general area near the regional park, and number of large parcels in the area are being redeveloped. These developments are projected to add an estimated 3,500 jobs and 575 housing units, which will likely increase usage of the regional park.

The Statewide Health Improvement Program (SHIP) is promoting people living longer, healthier lives through the reduction in obesity and increased physical activity. Anoka County has received SHIP grants to increase access to regional parks and trails and increase health and outdoor recreation awareness. The County also conducted the 2013 Anoka County Adult Health Survey. Findings from the survey will be used to identify priorities to support health and create awareness of the ways that communities, organizations and employers can support healthy adult lifestyles. Outdoor recreation and regional parks can play an important role in healthy lifestyles.

3. Development Concept: Most of the existing recreational amenities in Anoka County Riverfront Regional Park are located at the Riverfront portion of the park and include paved trails, picnic facilities, a playground, boat launch and observation deck. The Reidel Farm Estate is also located at Riverfront. The house was built in the 1880s and served as the home of Albin E. Reidel until it was sold to Northern Pump Company. Anoka County purchased the building in 1987 and now operates it as a special event facility. The Reidel Farm Estate is available to rent for meetings, weddings, receptions and other gatherings. The building is not open unless there is a reservation. Other structures at Riverfront include a gazebo, two picnic pavilions and two restroom buildings.

The Islands of Peace portion of the regional park includes trails on Chases Island that are accessible by a pedestrian bridge. Structures at Islands of Peace include the Islands of Peace Visitor Center, which is home to the Minnesota Recreation and Parks Association, and a small maintenance garage. Existing development within the regional park is shown in *Figure 4*.

Figure 4: Existing Development at Anoka County Riverfront Regional Park



Development proposed in the master plan amendment includes adding new facilities and amenities to the park as well as rehabilitating existing facilities and adding trail connections from East River Road.

Riverfront Development: At the southern portion of Riverfront, the roadway and parking lots will be reconfigured to accommodate a new 12-hole disc golf course, a 100 person capacity picnic pavilion and a new restroom building. The existing trails, picnic facilities and playground will remain, but will be rehabilitated as needed. The concept plan for the south portion of Riverfront is shown in *Figure 5*.

Figure 5: Concept Plan for the South Portion of Riverfront



The central portion of Riverfront will include a new maintenance facility, a larger gazebo shelter, a new outdoor plaza, and an observation deck at the river’s edge. The existing retaining wall will be reconstructed and lighting and utilities will be upgraded. The park entrance will also be modified to realign the entrance road, add trail connections, a new entrance sign and a gatehouse. The concept plan for the central portion of Riverfront is shown in *Figure 6*.

Figure 6: Concept Plan for the Central Portion of Riverfront



Development at the northern portion of Riverfront includes rehabilitation of existing facilities, including the picnic pavilion and restroom. The existing boat launch and parking lot will be reconstructed, and a small fishing deck and picnic area are proposed. The concept plan for the northern portion of Riverfront is shown in *Figure 7*.

Figure 7: Concept Plan for the North Portion of Riverfront

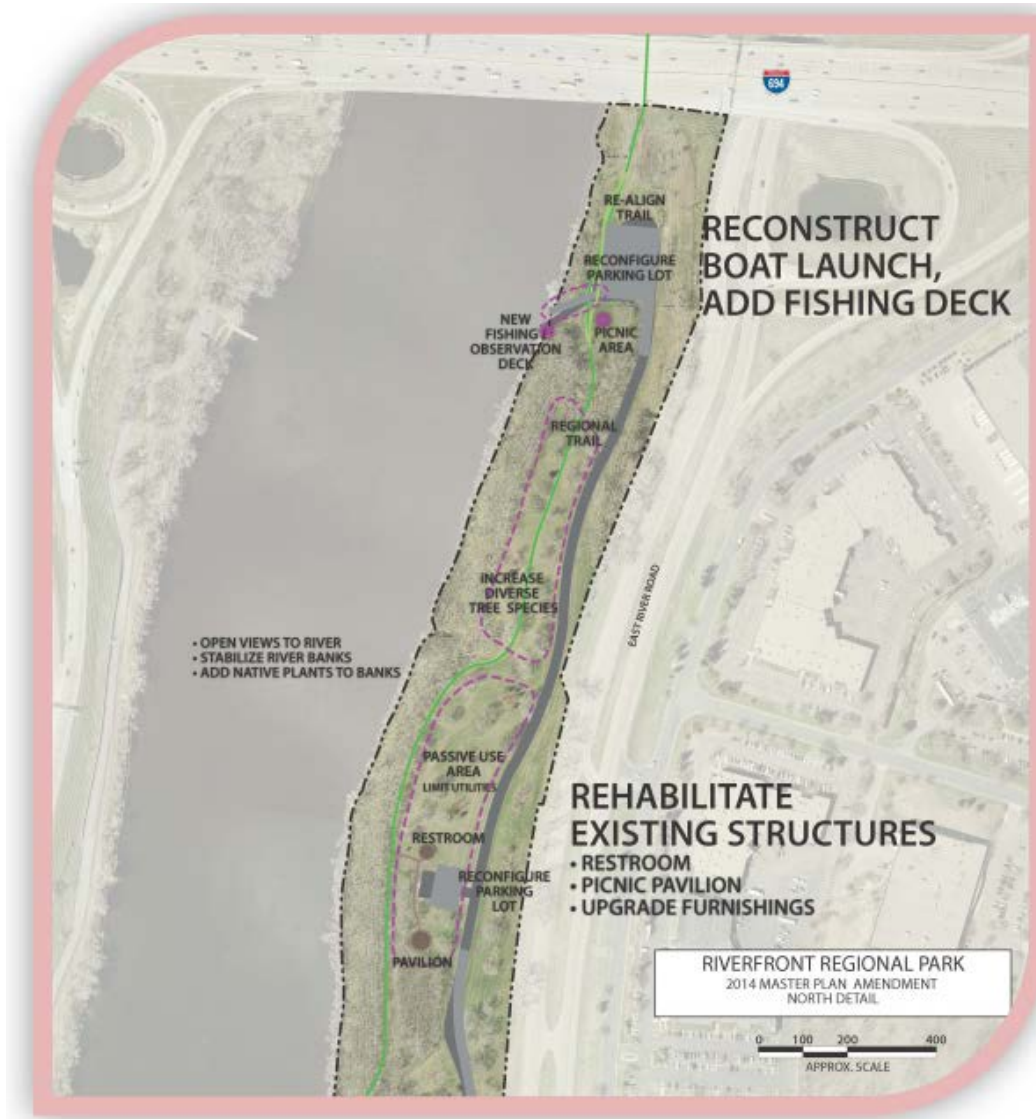

Islands of Peace Development: Development at Islands of Peace will include reconstructing and reconfiguring the parking lot, entrance drive and trails. The pedestrian bridge leading to Chases Island will need to be repaired or replaced in the future. The master plan identifies a new picnic pavilion, restroom building and playground, as well as a more formal canoe access on Chases Island. The future park expansion areas will allow for additional trail development. There is no development proposed for Durnam or Gil Hodges Islands. The concept plan for Islands of Peace is shown in *Figure 8*.

Figure 8: Concept Plan for Islands of Peace

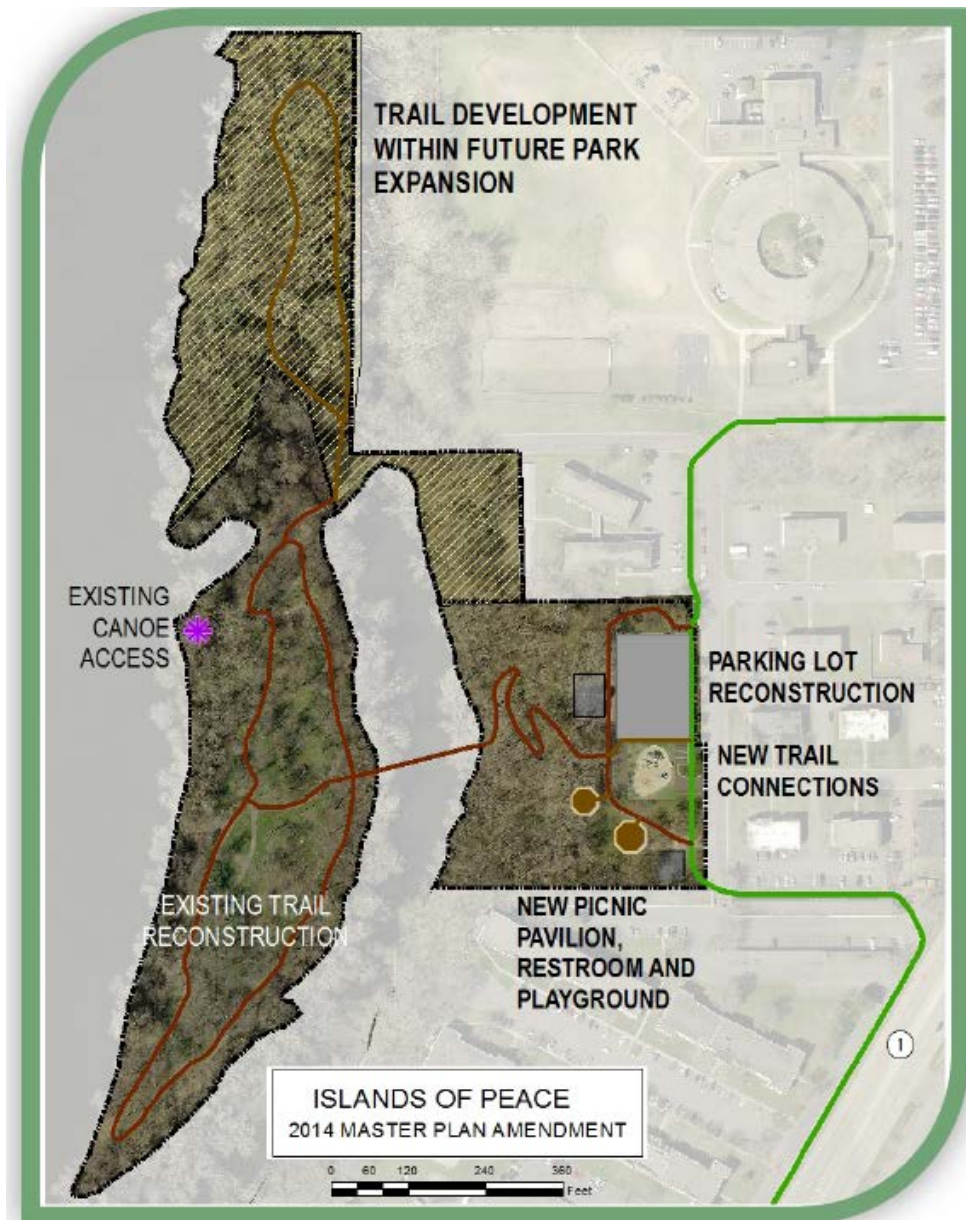

The estimated development costs to implement the master plan are \$5,300,000 and are detailed in *Figure 9*.

Figure 9: Estimated Development Costs of Anoka County Riverfront Regional Park

Description	Estimated Cost
Design Fees	\$250,000
Site Analysis Work	\$100,000
Rehab Existing Buildings	\$250,000
New Pavilion/Restroom (Riverfront)	\$350,000
Maintenance Facility (Riverfront)	\$600,000
Reconstruct Boat Launch (Riverfront)	\$50,000
Fishing/Observation Decks (Riverfront)	\$60,000
Reconstruct Retaining Wall/Gazebo/Plaza (Riverfront)	\$150,000
Disc Golf Course (Riverfront)	\$75,000
New Pavilion/Concessionaire Building (Islands of Peace)	\$400,000
Construct Canoe Launch (Islands of Peace)	\$20,000
Construct Playground (Islands of Peace)	\$80,000
Reconstruct Plaza (Islands of Peace)	\$35,000
Bridge Reconstruction (Islands of Peace)	\$300,000
Roads/Parking Lots/Trails	\$1,800,000
Entrance Sign	\$30,000
Landscaping/Natural Resource Restoration	\$75,000
Lighting/Utilities	\$125,000
Site Furnishings/Signage	\$50,000
Fees and Contingencies	\$500,000
TOTAL	\$5,300,000

4. Conflicts: Anoka County will work to keep conflicts to a minimum through proper planning and community involvement in development of the regional park. The Riverfront portion of the regional park is mostly surrounded by industrial and commercial land uses, while the Islands of Peace portion of the park is surrounded by residential and institutional land uses. Potential conflicts may be related to safety and security around the park. The County provides park ranger patrols and works with the City of Fridley Police and the Anoka County Sheriff’s Department to ensure that the park is safe and secure.

Potential conflicts between pedestrian and vehicular traffic will be kept to a minimum by reducing the number of trail and road crossings within the park and by working with the Anoka County Highway Department and City of Fridley to ensure safe crossings at road intersections. These crossings may include signage, striping and signalized pedestrian crossings. Signage within the regional park will alert visitors to these crossings and will provide wayfinding and interpretive information.

5. Public Services: There are a variety of existing public services, such as roadways, trails, restroom facilities, picnicking facilities, and parking already available to users at both the Riverfront and Islands of Peace areas of the regional park. While many of the existing public services are proposed to be reconstructed with this master plan amendment, no new public services are required or proposed to be installed.

6. Operations: The use of Anoka County's parks and trails is regulated through Anoka County Park Ordinance #2012-01 and is enforced by local police departments and the Anoka County Sheriff. County Park Rangers educate park visitors about park ordinances and also provide park information.

Anoka County will provide the on-going daily and general routine maintenance of the park, including mowing, sweeping, plowing, clearing, debris removal. Solid waste will be collected from trash and recycling receptacles. Anoka County will inspect the park and trails regularly and will provide any capital improvements. Park signs will be provided and maintained by the County.

Annual operations and maintenance costs for Anoka County Riverfront Regional Park are estimated to be approximately \$40,000. Annual operations and maintenance costs are funded through Anoka County's budget, which receives its funding from picnic shelter rentals, room rentals, programs, park entrance fees and the County's general fund. Supplemental funding is received from the State of Minnesota as part of the Operations and Maintenance Fund allocation administered by the Metropolitan Council.

The County takes into account energy efficiency and sustainable design when redeveloping its parks and trails. For example, the County uses remote building automation systems that have saved the department \$5,000 to \$10,000 per year compared to traditional energy monitoring systems. The County has a refuse and recycling policy that requires the recycling of paper and plastics and typically uses recycled materials in its buildings, where possible.

7. Citizen Participation: Anoka County worked with local governmental and regulatory agencies in the master planning process. The National Parks Service, US Army Corps of Engineers, Minnesota Department of Natural Resources, Rice Creek Watershed District and the City of Fridley were invited to share comments on the draft master plan. Anoka County held an open house on October 24, 2013 to gather feedback from the public. The comments that were received primarily focused on the lack of pedestrian access between the south portion of the regional park and East River Road as well as vegetation management within the park. These comments were addressed in the master plan.

The Anoka County Board of Commissioners unanimously approved the Anoka County Riverfront Regional Park Master Plan Amendment on January 14, 2014. Additionally, the City of Fridley passed a resolution of support for the master plan amendment on March 10, 2014.

8. Public Awareness: Anoka County Parks and Recreation provides public information and education about its facilities through maps, websites, social media, publications and brochures.

9. Accessibility: The facilities and amenities within the regional park will be developed in accordance with ADA standards and guidelines. Anoka County strives to provide equal access to its parks and trails. There is not a fee for entrance to the regional park, which eliminates economic barriers for park users. The Islands of Peace portion of the park is located along a Metro Transit bus route and is less than .5 mile from a Northstar Commuter Rail station. Additionally, Anoka County's "Traveler" program provides transportation services for a minimal fee to County citizens who are in need.

10. Natural Resources: The land cover at the Riverfront portion of the park consists of a mix of impervious surface, perennial grasses, non-native deciduous forest and maintained grasses. The upland area is relatively flat and does not include any wetlands as identified by the National Wetlands Inventory. At the river bluff, there are slopes averaging 30 percent down to the river, which makes the area susceptible to erosion.

Due to past ordnance and munitions manufacturing in the area, there is some environmental contamination at the south end of the park. The US Navy monitors the condition of this area on a regular basis. The Navy has installed a number of groundwater monitoring wells that range in depth from 20-150 feet, which are used to check water levels and take water samples to determine the amount of volatile organic compound contamination in the area. Soil borings are also taken periodically to determine the level of soil contamination. The Navy has also used injection wells to help determine the microbial biomass present. Since the contamination is located deep within the soil structure, the US Department of the Navy has stated that there is little to no health risk to the general public. The area of environmental conditions is shown in *Figure 10*.

Figure 10 Known Environmental Conditions at Anoka County Riverfront Regional Park



The Islands of Peace portion of the regional park consists of mostly floodplain forest with some silver maple subtype on the islands and the upland areas include impervious surface with some

perennial grasses and sparse trees. The topography in this area is also steep between the upland and the river. There are no known environmental contamination conditions at Islands of Peace.

The master plan indicates that in order to manage the natural resources and maintain natural connection to the river, Anoka County will provide for:

- The protection, restoration and enhancement of native plant and animal habitats throughout the park
- Protection and improvement of water and soil resources
- Increase public awareness regarding the natural resources of the area
- Sustainable practices related to park development, operations and maintenance

General natural resources management strategies include identifying and assessing remnant plant and animal communities, monitoring rare species, controlling invasive species, restoring native plant and animal habitat, controlling detrimental insects and disease, wildlife management, enhancing water quality, erosion control and cooperative land stewardship.

Protection of surface water resources is a top priority. The County will work closely with the City of Fridley, the local watershed district, the National Park Service's Mississippi National River and Recreation Area, the Minnesota Department of Natural Resources, and the Minnesota Pollution Control Agency to ensure that standards and requirements for resource protection are met.

Priority natural resource projects include:

- Removal of invasive species throughout the park
- Continued planting of trees and shrubs along East River Road and open turf areas to diversify the tree species
- Planting of native trees on Chases Island to replace trees lost due to diseases or storm damage
- Restoration of native prairie in the disc golf area at the Riverfront portion of the park
- Removal of Siberian Elms throughout the park

11. Stewardship: Anoka County will continue to manage the land and act as stewards to the regional park. Since the regional park is located along the Mississippi River and is part of the Mississippi National River and Recreation Area, natural resources play an important role in the overall health of the park. The County has conducted invasive species removal projects within the riparian area and has planted additional native trees and shrubs throughout the park. Anoka County also proposes to add a variety of tree and shrub species as part of the development concept for the regional park.

Review by Other Council Divisions

Environmental Services – Sewers (Roger Janzig 651-602-1119) – Metropolitan Council Interceptor 4-NS-521 runs adjacent to this regional park parallel to East River Road. The interceptor was built in 1965 and is a 96 inch reinforced concrete pipe at a depth of approximately 3 feet. To assess the potential impacts to our interceptor system, prior to initiating any development, preliminary plans should be sent to Scott Dentz, Interceptor Engineering Manager (651-602-4503) at the Metropolitan Council Environmental Services for review and comment.

Community Development – Environment and Surface Water Management (Jim Larsen 651-602-1159) – No comments.

Transportation Planning (Russ Owen 651-602-1724) – No comments.

Metro Transit (Steve Mahowald 612-349-7775) – No comments.

Conclusions

1. The Anoka County Regional Park Master Plan Amendment is consistent with the requirements of the *2030 Regional Parks Policy Plan* and other Council policies.

2. The estimated cost to implement the master plan is \$5,300,000 for development. The master plan proposes to add two parcels, totaling approximately 5 acres, to the regional park boundary. A 3.5 acre parcel is owned by the City of Fridley and a 1.5 acre parcel is currently privately owned, but the City is proposing to obtain the land through park dedication when the area is redeveloped. Both parcels would remain under City ownership; a Joint Power Agreement between Fridley and Anoka County would allow the County to operate and maintain the property as regional parkland. Therefore, there are no acquisition costs associated with the master plan.

3. A Metropolitan Council regional interceptor runs adjacent to the regional park, parallel to East River Road from the main park entrance at 51st Way NE to the southern boundary of the park. The interceptor as built in 1965 and is a 96 inch reinforced concrete pipe at a depth of approximately 3 feet. The master plan calls for modifications at the main entrance of the park, including realignment of the entrance road, new trail connections, a new entrance sign and a gatehouse as well as a new trail connection to a bus stop further south in the park. In order to maintain the integrity of the regional interceptor system, prior to initiating any construction, preliminary development plans for these facilities within the regional park should be submitted to Metropolitan Council Environmental Services for review and comment.

4. Approval of this master plan does not commit the Council to any funding at this time. Future development funding based on this master plan may be issued through the Regional Parks Capital Improvement Program (CIP) and Land Acquisition Opportunity Fund. Council action is required to approve the CIP and to approve specific grants to Anoka County.

AGENDA REPORT



Meeting Date: March 2, 2026
Meeting Type: Parks and Recreation Commission
Submitted By: Mike Maher, Parks and Recreation Director
Title: Discussion on the Impact of Federal Immigration Enforcement on Fridley Parks

Background

At the February 2, 2026 meeting of the Parks and Recreation Commission, Commissioner Jodi Rehlander requested that an agenda item be added to the March 2, 2026 meeting to allow the group to discuss the impacts of federal immigration enforcement efforts to Fridley's parks.

Commissioner Rehlander provided staff with a list of potential discussion items to guide the conversation including but not limited to:

- "Education and training for Parks & Recreation staff and the public, including permanent, temporary and seasonal workers, on allowed constitutional observer activities in public spaces;
- Creating or updating protocol for reporting emergency situations, including civil immigration enforcement activity, with clear actions that can and cannot be taken by program staff;
- Language in all Parks & Recreation mailers that reinforces the city's February 5 website update: "Reassurance to the Fridley Community: Every member of our community will receive fair and impartial service, regardless of immigration status. If you need help, call 9-1-1.";
- Permanent signage in the city's public spaces clearly stating how to engage Fridley Public Safety and encouraging the reporting of all suspected illegal activities.
- The above list is not exhaustive and all perspectives and ideas are welcome. We hope that by having this discussion and others we can keep the lines of communication open and build collaborative solutions that keep our public spaces welcoming, safe and ready for all the fun they can hold."

Recommendation

Attachments and Other Resources

1. [what-you-need-to-know-immigration-enforcement-english](#)

Vision Statement

We believe Fridley will be a safe, vibrant, friendly, and stable home for families and businesses.



What You Need to Know

Immigration Enforcement in the City of Fridley

Don't hesitate to call 9-1-1 if you need help

Reassurance to Our Community

Every member of our community will receive fair and impartial service, regardless of immigration status.

Fridley Police Will Not

- **Ask about a person's immigration status.**
- Conduct investigative stops or take action against an individual based solely on race, ethnicity or national origin.
- Share records with federal authorities (other than data requests governed by the State law).

Fridley Police Will

- Be easily identifiable by their badges, badge numbers, patches and/or vest placards.
- Respond if you have concerns about the legitimacy of any law enforcement officers.
- Operate in a professional and constitutional manner, without exception.

The Fridley Police Department **Does Not** Enforce Immigration

- The Fridley Police Department does not have the authority to engage in immigration enforcement.
- The Fridley Police Department cannot interfere with federal authorities who are conducting immigration enforcement in our community.

Fridley Police in Our Community

- Fridley Police Officers generally perform patrol operations in fully marked police vehicles (unmarked vehicles have Minnesota license plates and are compliant with State law).
- If a suspicious vehicle is attempting to conduct a traffic stop or box in an individual, that individual has the right to call 9-1-1 to verify the legitimacy of that vehicle.

Members of the Fridley Police Department, including police officers, school resource officers and community service officers will be in uniform and/or have clear Fridley Police markings on their squad car, vest or jacket.

See the back side of this information sheet for specific examples of Fridley Police uniforms and squad cars.



From left to right: Fridley Police patch and badge



What You Need to Know

Immigration Enforcement in the City of Fridley

Fridley Police will be easily identifiable by their badges, badge numbers, patches and/or vest placards.

Fridley Police Officers generally perform patrol operations in fully marked police vehicles. Unmarked vehicles have Minnesota license plates and are compliant with State law.



Police Officer



Police Officer (back of vest)



Community Service Officer, Reserve Officer and Police Explorer



School Resource Officer
(plain clothing with Fridley vest)



Fridley Squad Car



Fridley Squad Car (side)

If a suspicious vehicle is attempting to conduct a traffic stop or box in an individual, that individual has the right to call 9-1-1 to verify the legitimacy of that vehicle.

AGENDA REPORT



Meeting Date: March 2, 2026
Meeting Type: Parks and Recreation Commission
Submitted By: Mike Maher, Parks and Recreation Director
Title: Fridley Parks and Recreation Staff Report

Background

Attached is the update from the Fridley Parks and Recreation Staff for March 2, 2026 Parks and Recreation Commission meeting.

Recommendation

Attachments and Other Resources

1. Staff Report.Feb_Final 2026

Vision Statement

We believe Fridley will be a safe, vibrant, friendly, and stable home for families and businesses.



STAFF REPORT

Recreation Division: February 2026

Winter Programs

Below is a list of programs and participation numbers for those that took place in February.

Ages 15+

Immersive Soundbath: Feb 10	14
-----------------------------	----

Preschool: Ages 3-5

Games Galore (6 sessions): Feb-Mar	16
------------------------------------	----

Elementary – Middle School: Grades K-6

Games Galore (6 sessions): Feb-Mar	9
Tae Kwon Do (6 sessions): Feb-Mar	20
Slimy, Goopy, Sticky (6 sessions): Feb-Mar	15

Adult Fitness and Athletics

Zumba (6 sessions): Feb-Mar	10
Pickleball Skills & Drills: Feb F=6, SLP=6	12
Pickleball Ladder League All Ages: Jan-Mar F=25, SLP=20	45
Pickleball Ladder League Ages 20-40: Jan-Mar F=13, SLP=5	18
Volleyball Coed Rec: Jan-Mar*	10 teams
Volleyball Coed Comp: Jan-Mar*	10 teams
Volleyball Women's Comp: Jan-Mar*	10 teams
Bag Toss League Co-ed Jan-Mar*	10 pairs
Men's Basketball Leagues (2 Rec Leagues): Dec - Mar	17 teams

*North Metro Leagues are offered in cooperation with Mounds View, New Brighton, and Spring Lake Park.

Parks and Recreation Activity Guide

The March/April edition of the Activity Guide was mailed to residents beginning on February 23.

February Facility Rentals

Facility	Reservations
Moore Lake Community Building	13
Hayes Pickleball Courts	18 hours

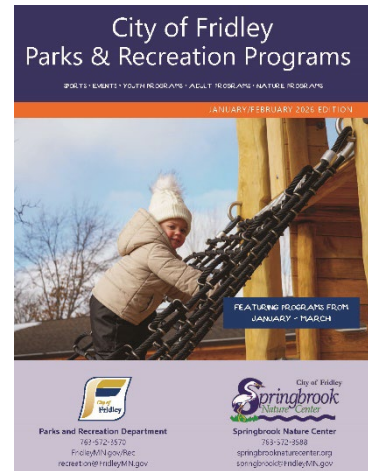

PRESCHOOL ACTIVITIES

PLAYFUL POLLWOGS
Join a fun-filled game where you'll learn to swim and play with water. We'll have water balloons, water guns, and water balloons. We'll have water balloons, water guns, and water balloons. We'll have water balloons, water guns, and water balloons.

AGES 12+

IMMERSIVE SOUNDBATH
Experience a new kind of sound therapy. We'll have water balloons, water guns, and water balloons. We'll have water balloons, water guns, and water balloons.

GAMES GALORE
Get ready to run and when you're done, each one will play a game. We'll have water balloons, water guns, and water balloons. We'll have water balloons, water guns, and water balloons.

NATURE PRESCHOOL CLUB
Bring your school bag to school for the day. We'll have water balloons, water guns, and water balloons. We'll have water balloons, water guns, and water balloons.

AFTER-SCHOOL ACTIVITIES

TAE KWON DO
Learn the basics of this martial art. We'll have water balloons, water guns, and water balloons. We'll have water balloons, water guns, and water balloons.

SIMY GOOPY STICKY
Bring your school bag to school for the day. We'll have water balloons, water guns, and water balloons. We'll have water balloons, water guns, and water balloons.

SUMMER ROCKS REGISTRATION OPENS AT 5 AM ON WEDNESDAY, MARCH 4

CAMP SPRINGBROOK REGISTRATION OPENS AT 5 AM ON WEDNESDAY, FEBRUARY 13

CAMP SPRINGBROOK AND SUMMER ROCKS PRE-REGISTRATION

Work with Us!

After-School Programs

Our current session of after school classes began during the week of February 17 and will run through mid-March. We have great enrollment in all our programs: Games Galore, Tae Kwon Do, and Slimy, Goey, Sticky. Participants have been enjoying the many activities offered.



Summer Recreation Internship

We are currently scoring applications for our summer internship. Interviews will take place in March. The position will begin at the end of May and end in August.

Commons Park Pickleball Courts

Staff are currently working on finalizing the formats and rules for the Commons Park Pickleball signage. Information on the sign will include structured open play rules, open play courts hours, and a QR code link to pickleball program schedule. A NEXTuP Paddle Saddle will be ordered soon so it will be installed in time for the courts to open in June.

Winterfest

The community joined us at Springbrook for a fun celebration of winter on Saturday, February 8 from 12 – 3 p.m. We estimate that 350 people came through to enjoy the many activities including: fat tire biking, campfires, photo booth, storytime, arts & crafts, games, scavenger hunts, winter gear grab, and the medallion hunt. New this year, we celebrated the Olympics with an exciting opening ceremony, fun challenges and children used a passport to collect medals throughout the events.

This event would not be possible without our many volunteers and partners. A huge thank you to the Fridley Lions for their financial sponsorship and for volunteering the day of the event. Also, Metropolitan Pediatric Dental Associates made a donation to the event and also passed out toothbrushes to participants. The following groups joined us to provide activities and information about their organizations: Anoka County Library Mississippi Branch, Minneapolis Titans Youth Hockey, Fridley Boy Scouts, Creative Flow Art Center, Coon Creek Watershed District, Fridley Public Safety Department (Fire and Police), Fridley Public Works, and Fridley Girl Scouts.



Upcoming Events and Programs

- March 4: Summer ROCKS Registration Opens
- March 7: Seed Swap at Moore Lake Community Building
- Family Open Gym and Pickleball Court Rentals end on March 28
- March 27: Spring Fling Dance
- April 1: April Fool's Scavenger Hunt

Springbrook Nature Center

February Education Programs

Program Participants: 228

Hours of Instruction: 306

February Rentals & Birthday Parties

February Birthday Parties	2
February Indoor Room Rentals	5

Grants

- A grant was submitted to the Xcel Energy Foundation on a project to install benches made from recycled wind turbines in the park. In addition, staff plans to include a local artist-led mural with an interpretive focus. Additional funding partners for this project are being contacted as the grant will not cover all expenses.

Park & Building Maintenance

- The Trail Resurfacing project is completed - for now. There will be spring touch-ups once the snow has left. We're excited for increased accessibility and reduced maintenance.
- The 85th Avenue boardwalk trail remains under evaluation. An engineering firm completed and evaluation of the existing structure and provided estimates for rehabilitation. Staff are looking at value engineering options as the estimates exceed the amount budgeted for the project.

Upcoming Events

Lantern Light Hikes

(6:30-8:30 pm, \$5 per person)

March 6

Bundle up and get ready to hike at Springbrook using the light of glowing lanterns to guide your way. Listen for owls hooting, keep your eyes peeled for elusive nocturnal animals, and warm up by the fire along the way. **Volunteers are needed for this event: Fire Tender, Lantern placement and pickup.**



Summer Camp Registration is Now Open!

Registration began February 25 at 8 am.

Find more information on our [website](#). See table for information on dates, themes, and descriptions of this year's camps!

Springbrook Spree



The poster features a large green circular graphic with the text "springbrook Spree" and "Nature's Night Out" in white. Below the text is the invitation: "Join us for an evening of compassion and community at this annual fundraiser!". Three photos are shown: a pond, people in a forest, and a snake. A "TICKETS" button is present, along with event details: "March 28, 2026 5 PM - 8:30 PM" and "Location: 100 85th Ave NE Fridley 55432". A QR code is provided for scanning, with a price of "\$55 per person" and a note that "price increases to \$65 on March 17".

springbrook Spree

Nature's Night Out

Join us for an evening of compassion and community at this annual fundraiser!



TICKETS

March 28, 2026
5 PM - 8:30 PM

Location:
100 85th Ave NE Fridley 55432

\$55 per person
price increases to \$65 on March 17

Scan for Tickets



CONTACT US
763-572-3588

WEBSITE
springbrooknaturecenter.org